

NOTICE!!

These documents have been scanned!

Do not place un-scanned documents beneath this notice!

Do not remove this notice from this file!

GPO Jacket No. 560-102
Print Order 61540
Rise Business Services, LLC
Job=AZ15 5/13/2019



Box Number= AZ15040



Claim Begin-End: AMC423063-AMC423063

1 Initial Receipt



AZ15040-13

AMC422569-AMC423150

United States Department of the Interior
Bureau of Land Management
 LANDS/RECREATION & PLANNING
 ONE N CENTRAL AVE
 PHOENIX, AZ 85004 -2203
 Phone: 602-417-9200

Receipt

No: 2787280

Transaction #: 2871894		ENTERED INTO COMPUTER
Date of Transaction: 05/06/2013		
CUSTOMER: JUN 10 2013 <i>pb</i>		
GARY L HALEY PO BOX 584 GREEN VALLEY, AZ 85622-0584 US		

LINE #	QTY	DESCRIPTION	REMARKS	UNIT PRICE	TOTAL
1	1.00	LOCATABLE MINERALS / MINING CLAIMS- NEW, UNADJUD, ONE OR MORE AUTH NOS / NEW MINING CLAIM LOCATION FEE \$34 CASES: AMC423063/\$34.00		- n/a -	34.00
2	1.00	LOCATABLE MINERALS / MINING CLAIMS- NEW, UNADJUD, ONE OR MORE AUTH NOS / NEW MINING CLAIM MAINT FEE \$140 CASES: AMC423063/\$140.00		- n/a -	140.00
3	1.00	LOCATABLE MINERALS / MINING CLAIMS- NEW, UNADJUD, ONE OR MORE AUTH NOS / NEW MINING CLAIM PROCESSING FEE \$15 CASES: AMC423063/\$15.00		- n/a -	15.00
TOTAL:					\$189.00

PAYMENT INFORMATION			
1	AMOUNT:	189.00	POSTMARKED: 05/02/2013
	TYPE:	CHECK	RECEIVED: 05/03/2013
	CHECK NO:	592	
	NAME:	HALEY, GARY L PO BOX 584 GREEN VALLEY AZ 85622-0584 US	

REMARKS

This receipt was generated by the automated BLM Collections and Billing System and is a paper representation of a portion of the official electronic record contained therein.

NOTICE!!

These documents have been scanned!

Do not place un-scanned documents beneath this notice!

Do not remove this notice from this file!

GPO Jacket No. 560-102
Print Order 61540
Rise Business Services, LLC
Job=AZ15 5/13/2019



Box Number= AZ15040



Claim Begin-End: AMC423063-AMC423063

2 Correspondence



AZ15040-13

AMC422569-AMC423150



United States Department of the Interior



BUREAU OF LAND MANAGEMENT
Arizona State Office
One North Central Avenue, Suite 800
Phoenix, Arizona 85004-4427
www.blm.gov/az/

OCT 30 2014

In Reply Refer To:
3800 (9310) RM
AMC418628, AMC421116, AMC421122,
AMC423063, AMC423064, AMC423704

CERTIFIED MAIL - RETURN RECEIPT REQUESTED No. 7014 0150 0000 5453 3086

NOTICE

GARY AND CONNIE HALEY : This Notice Affects Those Claims
PO BOX 584 : Shown in the Block Below.
GREEN VALLEY, AZ 85622-0584 :

AMC418628, AMC421116, AMC421122, AMC423063, AMC423064, AMC423704
PEACHIE, APACHE MOON, BUZZARDS END, HONEYCOMB, APACHE MOON 2,
SKID MARK

Affidavit of Performance of Annual Work or Notice of Intent to Hold Discrepancies

We have received your Affidavit of Performance of Annual Work (POL) or Notice of Intent to Hold (NOI) for the 2014 assessment year for the mining claims listed above. However, there was a discrepancy as noted below:

We received the POL document and processing fee. You also filed an incomplete NOI. We did not receive page 1 of the NOI nor the processing fee for the NOI. The processing fee for a NOI is \$10 per claim. In accordance with Title 43 Code of Federal Regulations (CFR) 3830.91(8) you are allowed 30 days from the date you receive this Notice (or December 30, 2014, whichever is later) to pay the additional fees. If we do not receive your payment and completed NOI within this time frame, your documents will not be recorded by BLM and your mining claims will be closed. Any non-refundable processing fees already paid will be forfeited. The NOI is the document that is required to be filed the first year you are filing a waiver. Enclosed is a NOI form for your use.

Please correct the discrepancy and submit the requested documents or fee within 30 days from your receipt of this letter. If we do not receive the correct documents or processing fee within this 30-day time frame the claims will be declared forfeited.

*FILED COMPLETED
NOV 14/17/2014. RM*

If additional information is required, please contact RéAnn Myers at 602-417-9413. Please include your AMC serial number(s) on all correspondence.

Sincerely,

A handwritten signature in cursive script that reads "Rebecca Heick".

Rebecca Heick
Acting Deputy State Director
Lands and Minerals Division

Enclosure

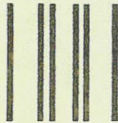

First-Class Mail
Postage & Fees Paid
USPS
Permit No. G-10

• Sender: Please print your name, address, and ZIP+4 in this box •

**U.S. DEPARTMENT OF THE INTERIOR
BUREAU OF LAND MANAGEMENT
ARIZONA STATE OFFICE
ONE NORTH CENTRAL AVENUE, SUITE 800
PHOENIX, AZ 85004-4427**

SENDER, COMPLETE THIS SECTION

- Complete items 1, 2, and 3. Also complete item 4 if Restricted Delivery is desired.
- Print your name and address on the reverse so that we can return the card to you.
- Attach this card to the back of the mailpiece, or on the front if space permits.

1. Article Addressed to:

GARY AND CONNIE HALEY
PO BOX 584
GREEN VALLEY, AZ 85622-0584

423063 / 423064 / 423704

AZ 931 / RM / 418628 / 421116 / 421122

2. Article Number

7014 0150 0000 5453 3086

(Transfer from service label)

COMPLETE THIS SECTION ON DELIVERY

A. Signature

X Gary Haley

Agent

Addressee

B. Received by (Printed Name)

GARY HALEY

C. Date of Delivery

11-12-14

D. Is delivery address different from item 1? Yes

If YES, enter delivery address below: No

2014 NOV 13 P 2: 17

PHOENIX, ARIZONA

3. Service Type

Certified Mail®

Priority Mail Express™

Registered

Return Receipt for Merchandise

Insured Mail

Collect on Delivery

4. Restricted Delivery? (Extra Fee)

Yes

NOTICE!!

These documents have been scanned!

Do not place un-scanned documents beneath this notice!

Do not remove this notice from this file!

GPO Jacket No. 560-102
Print Order 61540
Rise Business Services, LLC
Job=AZ15 5/13/2019



Box Number= AZ15040



Claim Begin-End: AMC423063-AMC423063

3 Transfers



AZ15040-13

AMC422569-AMC423150

**NO
DOCUMENTS
FOUND**

NO DOCUMENTS FOUND
NO DOCUMENTS FOUND

NOTICE!!

These documents have been scanned!

Do not place un-scanned documents beneath this notice!

Do not remove this notice from this file!

GPO Jacket No. 560-102
Print Order 61540
Rise Business Services, LLC
Job=AZ15 5/13/2019



Box Number= AZ15040



Claim Begin-End: AMC423063-AMC423063

4 Miscellaneous



AZ15040-13

AMC422569-AMC423150

**NO
DOCUMENTS
FOUND**

NO DOCUMENTS FOUND
NO DOCUMENTS FOUND

NOTICE!!

These documents have been scanned!

Do not place un-scanned documents beneath this notice!

Do not remove this notice from this file!

GPO Jacket No. 560-102
Print Order 61540
Rise Business Services, LLC
Job=AZ15 5/13/2019



Box Number= AZ15040



Claim Begin-End: AMC423063-AMC423063

5 Annual Filings



AZ15040-13

AMC422569-AMC423150

AFFIDAVIT OF ANNUAL ASSESSMENT WORK

418628
421122
421116
423064
423063
423704

WHEN RECORDED, MAIL DOCUMENT TO:

NAME: Gary + Connie Haley
ADDRESS: PO Box 584
CITY, STATE, ZIP: Green Valley, AZ 85622

FOR COUNTY RECORDER'S USE

No. of Claims 6
x \$10/claim
Total due BLM \$ 60.00

TO ALL WHOM IT MAY CONCERN:

1. The undersigned certifies that at least \$100 per claim was expended for development, labor and improvements, or equivalent value added, as the annual assessment work for the assessment year ending September 1, 2018 for the following contiguous unpatented mining claim(s), located in the County of Pima, in the State of Arizona.

BLM Serial No.	Name of Claim	Tp	Rg	Sec	Mer	County Recordation Book and Page No.	Co. Recording Date
418628	Peachie	17 S	12 E	003	Gila & S	20123130204 page 3	11/08/2012
421122	Buzzards End	17 S	10 E	026	Gila & S	20130590127 page 2	2/28/2013
421116	Apache Moon	17 S	10 E	026	Gila & S	20130590128 page 2	2/28/2013
423064	Apache Moon 2	17 S	10 E	026	Gila & S	20131420840 page 3	5/22/2013
423063	Honeycomb	17 S	10 E	026	Gila & S	20131420839 page 3	5/22/2013
423704	Skid Mark	17 S	10 E	026	Gila & S	20132050174 page 2	7/24/2013

(Continued on page 2)

RECEIVED
BLM AZ STATE OFFICE
2018 AUG 29 P 3:02
PHOENIX, ARIZONA

#4250500

ENTERED
SEP 06 2018
BY: RAM

2. Type of labor and improvements (specify what was done and give the total value for that labor and improvement to show at least \$100 for each claim). If a geological, geochemical, or geophysical survey was performed, as per 30 U.S.C. 28-1, reference the title of the report of survey, give cost and date of the survey and report, and indicate it was filed with the County Recorder:

Description of Work Performed	Value of Work Performed	Date Work Was Performed
checked/fixe d markers, Trime d brush, Trail fix	\$ 250.	3, 19, 2018
Road work, Trash hauling, marker repair	\$ 300.	4, 2, 2018
Trime d tree's and Path improved	\$ 150.	4, 16, 2018
cleare d Rock slide + Trash	\$ 400.	5, 14, 2018
Filled 3 potholes, cleare d brush + trash	\$ 200.	5, 28, 2018

3. Name and mailing address of each person who performed the labor and improvements:

Name (please print)

Gary Haley
 Connie Haley

Current Mailing Address (please print)

PO Box 584, Green Valley, AZ 85622
 PO Box 584, Green Valley, AZ 85622

4. Name and mailing address of each person who holds and claims the subject mining claim(s) for the valuable minerals contained therein. Be sure to indicate if there is a change of address:

Name (please print)

Gary Haley
 Connie Haley

Current Mailing Address (please print)

PO Box 584, Green Valley, AZ 85622
 PO Box 584, Green Valley, AZ 85622

RECEIVED
 BLM AZ STATE OFFICE
 2018 AUG 29 P 3:02
 PHOENIX, ARIZONA

5. The undersigned testifies that on the date of August, 28, 2018, all monuments required by law were erected upon the subject claim(s), and all notices required by law were posted on the subject claim(s) or copies thereof were in place, and at said date, each corner monument bore or contained

markings sufficient to appropriately designate the corner of the claim to which it pertains and the name of the claim(s).

I hereby certify under penalty of perjury under the laws of the State of Arizona that the foregoing statements are true and correct:

Mary Haley; Connie Lee Y. Haley Date: 8-27-2018
(Signature of person responsible for above statement)

Title 18 U.S.C. 1001 and 43 U.S.C. 1212 make it a crime for any person knowingly and willfully to make to any department or agency of the United States any false, fictitious or fraudulent statements or representations as to any matter within its jurisdiction.

Notary Block

SUBSCRIBED AND SWORN TO before me, this 27 day of August 20 18

By: Andrea Villa
(Signature of Affiant)

Title: Notary Public

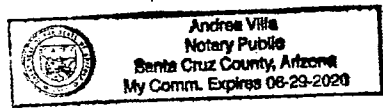

My Commission Expires: 08/29/2020

INSTRUCTIONS

1. This is an optional form that may be used to satisfy the requirements for the Bureau of Land Management (BLM) under the provisions of 43 U.S.C. §1744 and 30 U.S.C. §28-28d and the regulations thereunder (43 CFR part 3835). Since local and State laws may vary, you should contact your local and State agencies where the claims are located to ensure all applicable laws and requirements are satisfied.
2. The claimant(s) must fill in the date in paragraph 1 for the applicable assessment year and the county and state where the claims are located.
3. All claim names, BLM serial numbers, legal descriptions, and original county recording information must be listed for the claims pertaining to this assessment notice.
4. The claimant(s) must complete paragraph 2 listing all labor or improvements which was performed on or did benefit the subject mining claims. The value and date of the labor or improvements must also be listed. The total amount of labor or improvements can be listed, but the total expenditure must equal at least \$100 for each claim.
5. The names and current mailing addresses of the person(s) performing the labor shall be listed in paragraph 3.
6. The name and current mailing address of each owner (claimant) of the claims shall be listed in paragraph 4. The mailing address shall be the owner's address and not the address of an agent or anyone representing the claimant. Be sure to note if there has been a change of address.
7. Paragraph 5 shall be completed to show the date it was verified that all monuments required by law were properly erected, all notices were posted, and that corners were appropriately designated for all claims listed.
8. An exact legible reproduction or duplicate (other than microfilm or other electronic media) of this affidavit, another type of affidavit of assessment work that you file or will file in the county where each claim is located, must be filed with the BLM on or before December 30 of the calendar year in which the assessment year ends. For mill or tunnel sites, a separate notice of intent to hold must be filed with the BLM on or before December 30. Requirements for filing a notice of intent to hold can be found at 43 CFR 3835.33.
9. A processing fee of \$10 for each claim listed must be remitted to the BLM along with this or any other affidavit of assessment work.

RECEIVED
BLM AZ STATE OFFICE
788 AUG 29 PM 3:02
PHOENIX ARIZONA

Gary Haley
Phone: (520) 648-2040



Ms. Connie Haley
 PO Box 584
 Green Valley, AZ 85622

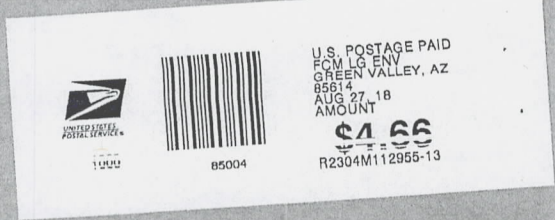

**UNITED STATES
 DEPARTMENT OF INTERIOR**
 Bureau of Land Management
 Arizona State Office
 One North Central Avenue, Suite 800
 Phoenix, Arizona 85004-4427

RECEIVED
 BLM STATE OFI
 2018 AUG 29 P 3:02
 PHOENIX, ARIZONA

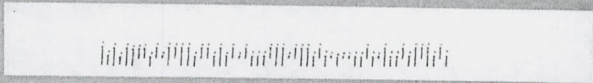

United States Department of the Interior
Bureau of Land Management
 DIV OF LANDS, MINRLS & ENERGY
 ONE N CENTRAL AVE
 PHOENIX, AZ 85004 -4427
 Phone: 602-417-9200

Receipt

No: 4250500

Transaction #: 4366005	
Date of Transaction: 08/30/2018	
CUSTOMER:	
GARY L HALEY PO BOX 584 GREEN VALLEY, AZ 85622-0584 US	

LINE #	QTY	DESCRIPTION	REMARKS	UNIT PRICE	TOTAL
1	1.00	LOCATABLE MINERALS / MINING CLAIMS- NOT NEW-UNADJUD, ONE AUTH NO. ONLY / MINING CLAIM MONEY RECEIVED CASES: AMC418628/\$60.00	POL 2018/6 WAV	- n/a -	60.00
TOTAL:					\$60.00

PAYMENT INFORMATION			
1	AMOUNT:	60.00	POSTMARKED: N/A
	TYPE:	CHECK	RECEIVED: 08/29/2018
	CHECK NO:	1499	
	NAME:	HALEY, GARY L PO BOX 584 GREEN VALLEY AZ 85622-0584 US	

REMARKS

This receipt was generated by the automated BLM Collections and Billing System and is a paper representation of a portion of the official electronic record contained therein.

UNITED STATES
DEPARTMENT OF THE INTERIOR
BUREAU OF LAND MANAGEMENT

MAINTENANCE FEE WAIVER CERTIFICATION

SEE INSTRUCTIONS ON PAGE 2

AMC 418628
421122
FORM APPROVED 421116
OMB NO. 1004-0114
Expires: January 31, 2020
423064
423063
423704

Handwritten signature

- This small miner waiver is filed for the assessment year beginning on September 1, ~~2017~~ and ending on September 1, ~~2018~~ ¹⁹ *sc*
- The undersigned and all related parties owned ten or fewer mining claims, mill, or tunnel sites located and maintained on Federal lands in the United States of America on September 1, 2018.
- The undersigned have performed the assessment work required by law for each mining claim listed prior to filing this waiver and understand that by filing this form, the undersigned must file an affidavit of assessment work with the Bureau of Land Management (BLM) by the December 30th following the filing of this waiver.
- The undersigned understand that if the assessment work obligation has not yet come due under 30 U.S.C. 28 (for those claims in their first assessment year only), a notice of intent to hold reciting this condition must be recorded by the December 30th following the filing of this waiver.
- The undersigned understand that mill and tunnel sites may also be listed on this waiver and be waived from payment of the maintenance fee, and that a notice of intent to hold for these sites is required to be filed with the BLM by the December 30th following the filing of this waiver.
- The undersigned understand and acknowledge that pursuant to 43 U.S.C. 1212 and 18 U.S.C. 1001, the filing or recording of a false, fictitious, or fraudulent document with the BLM may result in a fine of up to \$250,000, a prison term not to exceed five years, or both.
- The mining claims, mill or tunnel sites for which this waiver from payment of the maintenance fees is requested are:

CLAIM OR SITE NAME	BLM RECORDATION SERIAL NUMBER
1. Peachie	418628 (913)
2. Buzzards End	421122
3. Apache Moon	421116
4. Apache Moon 2	423064
5. Honeycomb	423063
6. Skidmark	423704
7.	
8.	
9.	
10.	

The owner(s) (claimants) of the above mining claims and sites are:

Connie Haley
(Owner's Name - Please Print)
PO Box 584, Green Valley, AZ 85622
(Owner's Mailing Address)

Connie Lee Haley
(Owner's Signature)
Green Valley AZ 85622
(City) (State) (Zip Code)

Gary Haley
(Owner's Name - Please Print)
PO Box 584, Green Valley, AZ 85622
(Owner's Mailing Address)

Gary Haley
(Owner's Signature)
Green Valley AZ 85622
(City) (State) (Zip Code)

(Owner's Name - Please Print)

(Owner's Mailing Address)

(Owner's Name - Please Print)

(Owner's Mailing Address)

(Owner's Signature)

(City) (State) (Zip Code)

(Owner's Signature)

(City) (State) (Zip Code)

RECEIVED
BLM AZ STATE OFFICE
PHOENIX, ARIZONA
2018 AUG 29 3:02

(Continued on page 2)

483
ENTERED
SEP 10 2018
BY: *[Signature]*

nwd

Connie Haley
(Owner's Name - Please Print)

X Connie L. Haley
(Owner's Signature)

PO Box 584
(Owner's Mailing Address)

Green Valley AZ 85622
(City) (State) (Zip Code)

Gary Haley
(Owner's Name - Please Print)

X Gary Haley
(Owner's Signature)

PO Box 584
(Owner's Mailing Address)

Green Valley AZ 85622
(City) (State) (Zip Code)

(Owner's Name - Please Print)

(Owner's Signature)

(Owner's Mailing Address)

(City)

(State)

(Zip Code)

(Owner's Name - Please Print)

(Owner's Signature)

(Owner's Mailing Address)

(City)

(State)

(Zip Code)

18 U.S.C. 1001 and 43 U.S.C. 1212 make it a crime for any person knowingly and willfully to make to any department or agency of the United States any false, fictitious or fraudulent statements or representations as to any matter within its jurisdiction.

INSTRUCTIONS

1. This certification is made under the provisions of 43 U.S.C. § 1744 and 30 U.S.C. §28-28k and the regulations thereunder (43 CFR Part 3830).
2. The claimant(s) must fill in the dates in paragraph 1 for the beginning and ending of the assessment year for which this waiver is sought.
3. The claimant(s) must fill in the date in paragraph 2 for the beginning of the assessment year for which this waiver is sought.
4. All claim and site names and BLM serial numbers must be listed for the mining claims, mill sites, and tunnel sites for which the waiver is sought.
5. All owners of the mining claims, mill sites, and tunnel sites and their addresses must be given.
6. This waiver form must be signed by all the claimants or their designated agent, in original form. If an agent is designated, a notarized designation of agent, signed by all of the claimants with proper address given, must be submitted with this waiver.
7. This form must be filed no later than September 1st for the upcoming assessment year in the BLM State Office where the mining claims or sites are recorded, or the waiver cannot be granted by the BLM. (Example: To obtain a waiver for the assessment year 2012, which begins on September 1, 2011, you must qualify for and file for a waiver no later than September 1, 2011, in the proper BLM State Office.)
8. For all mining claims which require assessment work, you must record an affidavit of labor on or before the December 30th immediately following the filing of this waiver. For all other mining claims or sites waived, you must record a notice of intent to hold on or before the December 30th immediately following the filing of this waiver.
9. Mill and tunnel sites may also be listed on this waiver and be waived from payment of the maintenance fee. A notice of intent to hold for these sites is required to be filed by the December 30th following the filing of this waiver.

RECEIVED
BLM ARIZONA STATE OFFICE
2011 AUG 29 P 3:02
PHOENIX, ARIZONA
FOR OFFICIAL USE ONLY

(Continued on page 3)

(Form 3830-2, page 2)

Gary Haley
Phone (520) 648-2040

Amc 418628
 421116
 421122
 423063
 423064
 423704

429

[Handwritten signature]

Print

Clear

Form 3830-2
 (January 2017)

UNITED STATES
 DEPARTMENT OF THE INTERIOR
 BUREAU OF LAND MANAGEMENT
 MAINTENANCE FEE WAIVER CERTIFICATION

FORM APPROVED
 OMB NO. 1004-0114
 Expires: January 31, 2020

SEE INSTRUCTIONS ON PAGE 2

1. This small miner waiver is filed for the assessment year beginning on September 1, ~~2016~~ ²⁰¹⁷ and ending on September 1, ~~2017~~ ²⁰¹⁸.
2. The undersigned and all related parties owned ten or fewer mining claims, mill, or tunnel sites located and maintained on Federal lands in the United States of America on September 1, ~~2017~~ ²⁰¹⁷.
3. The undersigned have performed the assessment work required by law for each mining claim listed prior to filing this waiver and understand that by filing this form, the undersigned must file an affidavit of assessment work with the Bureau of Land Management (BLM) by the December 30th following the filing of this waiver.
4. The undersigned understand that if the assessment work obligation has not yet come due under 30 U.S.C. 28 (for those claims in their first assessment year only), a notice of intent to hold reciting this condition must be recorded by the December 30th following the filing of this waiver.
5. The undersigned understand that mill and tunnel sites may also be listed on this waiver and be waived from payment of the maintenance fee, and that a notice of intent to hold for these sites is required to be filed with the BLM by the December 30th following the filing of this waiver.
6. The undersigned understand and acknowledge that pursuant to 43 U.S.C. 1212 and 18 U.S.C. 1001, the filing or recording of a false, fictitious, or fraudulent document with the BLM may result in a fine of up to \$250,000, a prison term not to exceed five years, or both.
7. The mining claims, mill or tunnel sites for which this waiver from payment of the maintenance fees is requested are:

CLAIM OR SITE NAME	BLM RECORDATION SERIAL NUMBER
1. Peachie	✓ 418628
2. Buzzards End	421122
3. Apache Moon	421116
4. Apache moon 2	423064
5. Honeycomb	423063
6. Skid Mark	423704
7.	
8.	
9.	
10.	

The owner(s) (claimant) of the above mining claims and sites are:

Connie Haley
 (Owner's Name - Please Print)
PO Box 584, Green Valley, AZ 85622
 (Owner's Mailing Address)

X Connie Lee Haley
 (Owner's Signature)
Green Valley AZ 85622
 (City) (State) (Zip Code)

Gary Haley
 (Owner's Name - Please Print)
PO Box 584, Green Valley, AZ 85622
 (Owner's Mailing Address)

X Gary Haley
 (Owner's Signature)
Green Valley AZ 85622
 (City) (State) (Zip Code)

(Owner's Name - Please Print)
 (Owner's Mailing Address)
 (Owner's Name - Please Print)
 (Owner's Mailing Address)

(Owner's Signature)
 (City) (State) (Zip Code)
 (Owner's Signature)
 (City) (State) (Zip Code)

(Continued on page 2)

RECEIVED
 BLM STATE OFFICE
 PHOENIX, ARIZONA
 2017 AUG 23 A 7:51

483
 INTERE
 SEP 12 2017
 BY: pr

[Handwritten initials]

Connie Haley
(Owner's Name - Please Print)
PO Box 584
(Owner's Mailing Address)

X Connie Lee Haley
(Owner's Signature)
Green Valley AZ 85622
(City) (State) (Zip Code)

Gary Haley
(Owner's Name - Please Print)
PO Box 584
(Owner's Mailing Address)

X Gary Haley
(Owner's Signature)
Green Valley AZ 85622
(City) (State) (Zip Code)

(Owner's Name - Please Print)
(Owner's Mailing Address)

(Owner's Signature)
(City) (State) (Zip Code)

(Owner's Name - Please Print)
(Owner's Mailing Address)

(Owner's Signature)
(City) (State) (Zip Code)

18 U.S.C. 1601 and 43 U.S.C. 1212 make it a crime for any person knowingly and willfully to make to any department or agency of the United States any false, fictitious or fraudulent statements or representations as to any matter within its jurisdiction.

INSTRUCTIONS

1. This certification is made under the provisions of 43 U.S.C. § 1744 and 30 U.S.C. §§ 28-28k and the regulations thereunder (43 CFR Part 3830).
2. The claimant(s) must fill in the dates in paragraph 1 for the beginning and ending of the assessment year for which this waiver is sought.
3. The claimant(s) must fill in the date in paragraph 2 for the beginning of the assessment year for which this waiver is sought.
4. All claim and site names and BLM serial numbers must be listed for the mining claims, mill sites, and tunnel sites for which the waiver is sought.
5. All owners of the mining claims, mill sites, and tunnel sites and their addresses must be given.
6. This waiver form must be signed by all the claimants or their designated agent, in original form. If an agent is designated, a notarized designation of agent, signed by all of the claimants with proper address given, must be submitted with this waiver.
7. This form must be filed no later than September 1st for the upcoming assessment year in the BLM State Office where the mining claims or sites are recorded, or the waiver cannot be granted by the BLM. (Example: To obtain a waiver for the assessment year 2012, which begins on September 1, 2011, you must qualify for and file for a waiver no later than September 1, 2011, in the proper BLM State Office.)
8. For all mining claims which require assessment work, you must record an affidavit of labor on or before the December 30th immediately following the filing of this waiver. For all other mining claims or sites waived, you must record a notice of intent to hold on or before the December 30th immediately following the filing of this waiver.
9. Mill and tunnel sites may also be listed on this waiver and be waived from payment of the maintenance fee. A notice of intent to hold for these sites is required to be filed by the December 30th following the filing of this waiver.

PHOENIX, ARIZONA
 2011 AUG 23 A 7:51
 RECEIVED
 BLM AZ STATE OFFICE
 FOR OFFICIAL USE ONLY
 Form 382-1, page 2

(Continued on page 3)

Gary Haley
Phone # (520) 648-2040

418628
 421122
 421116
 423704
 423064
 423063

Form 3830-4
 (January 2017)

UNITED STATES
 DEPARTMENT OF THE INTERIOR
 BUREAU OF LAND MANAGEMENT

FORM APPROVED
 OMB NO.: 1004-0114
 Expires: January 31, 2020

AFFIDAVIT OF ANNUAL ASSESSMENT WORK

WHEN RECORDED, MAIL DOCUMENT TO:

NAME: Gary + Connie Haley

ADDRESS: Po Box 584

CITY, STATE, ZIP: Green Valley, AZ 85622

FOR COUNTY RECORDER'S USE

No. of Claims 6
 x \$10/claim
 Total due BLM \$ 60.00

TO ALL WHOM IT MAY CONCERN:

1. The undersigned certifies that at least \$100 per claim was expended for development, labor and improvements, or equivalent value added, as the annual assessment work for the assessment year ending September 1, 2017 for the following contiguous unpatented mining claim(s), located in the County of Pima, in the State of Arizona.

BLM Serial No.	Name of Claim	Tp	Rg	Sec	Mer	County Recordation Book and Page No.	Date
418628	Peachie	17 S	12 E	003	Gila & S	20123130204 page 3	11/08/2012
421122	Buzzards End	17 S	10 E	026	Gila & S	20130590127 page 2	2/28/2013
421116	Apache Moon	17 S	10 E	026	Gila & S	20130590128 page 2	2/28/2013
423064	Apache Moon 2	17 S	10 E	026	Gila & S	20131420840 page 3	5/22/2013
423063	Honeycomb	17 S	10 E	026	Gila & S	20131420839 page 3	5/22/2013
423704	Skid Mark	17 S	10 E	026	Gila & S	20132050174 page 2	7/24/2013

(Continued on page 2)

3954860

RECEIVED
 AUG 29 2017
 BY: R Am

RECEIVED
 BLM AZ STATE OFFICE
 2017 AUG 23 A 7:51
 PHOENIX, ARIZONA

2. Type of labor and improvements (specify what was done and give the total value for that labor and improvement to show at least \$100 for each claim). If a geological, geochemical, or geophysical survey was performed, as per 30 U.S.C. 28-1, reference the title of the report of survey, give cost and date of the survey and report, and indicate it was filed with the County Recorder.

Description of Work Performed	Value of Work Performed	Date Work Was Performed
Filled potholes, Cleared brush, Removed trash	\$400.	3, 20, 17
Checked + fixed claim markers, Removed trash	\$150.	4, 16, 17
Improved Path, fixed markers	\$175.	4, 24, 17
Trimmed trees, cleaned trash	\$200.	5, 15, 17
Moved Rocks from Road, Removed trash, Markers	\$250.	5, 29, 17

3. Name and mailing address of each person who performed the labor and improvements:

Name (please print)

Gary Haley
 Connie Haley

Current Mailing Address (please print)

PO BOX 584, Green Valley, AZ 85622
 PO BOX 584, Green Valley, AZ 85622

4. Name and mailing address of each person who holds and claims the subject mining claim(s) for the valuable minerals contained therein. Be sure to indicate if there is a change of address:

Name (please print)

Gary Haley
 Connie Haley

Current Mailing Address (please print)

PO BOX 584, Green Valley, AZ 85622
 PO BOX 584, Green Valley, AZ 85622

5. The undersigned testifies that on the date of August 22, 2017, all monuments required by law were erected upon the subject claim(s), and all notices required by law were posted on the subject claim(s) or copies thereof were in place, and at said date, each corner monument bore the following:

(Continued on page 3)

RECEIVED
 STATE OFFICE
 PHOENIX, ARIZONA
 2017 AUG 23 A 1:52

markings sufficient to appropriately designate the corner of the claim to which it pertains and the name of the claim(s).

I hereby certify under penalty of perjury under the laws of the State of Arizona that the foregoing statements are true and correct:

Gary L. Haley Gary Haley Date: 8-21-2017
(Signature of person responsible for above statement)

Title 18 U.S.C. 1001 and 43 U.S.C. 1212 make it a crime for any person knowingly and willfully to make to any department or agency of the United States any false, fictitious or fraudulent statements or representations as to any matter within its jurisdiction.

Notary Block

SUBSCRIBED AND SWORN TO before me, this 21st day of August 2017

By: Rose Mendoza
(Signature of Affiant)

Title: NOTARY

My Commission Expires: OCT. 28, 2018

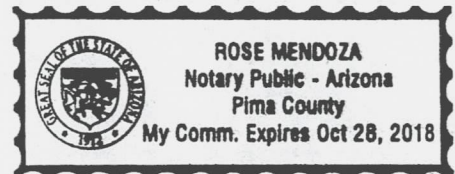

INSTRUCTIONS

1. This is an optional form that may be used to satisfy the requirements for the Bureau of Land Management (BLM) under the provisions of 43 U.S.C. §1744 and 30 U.S.C. §28-28d and the regulations thereunder (43 CFR part 3835). Since local and State laws may vary, you should contact your local and State agencies where the claims are located to ensure all applicable laws and requirements are satisfied.
2. The claimant(s) must fill in the date in paragraph 1 for the applicable assessment year and the county and state where the claims are located.
3. All claim names, BLM serial numbers, legal descriptions, and original county recording information must be listed for the claims pertaining to this assessment notice.
4. The claimant(s) must complete paragraph 2 listing all labor or improvements which was performed on or did benefit the subject mining claims. The value and date of the labor or improvements must also be listed. The total amount of labor or improvements can be listed, but the total expenditure must equal at least \$100 for each claim.
5. The names and current mailing addresses of the person(s) performing the labor shall be listed in paragraph 3.
6. The name and current mailing address of each owner (claimant) of the claims shall be listed in paragraph 4. The mailing address shall be the owner's address and not the address of an agent or anyone representing the claimant. Be sure to note if there has been a change of address.
7. Paragraph 5 shall be completed to show the date it was verified that all monuments required by law were properly erected, all notices were posted, and that corners were appropriately designated for all claims listed.
8. An exact legible reproduction or duplicate (other than microfilm or other electronic media) of this affidavit or another type of affidavit of assessment work that you file or will file in the county where each claim is located must be filed with the BLM on or before December 30 of the calendar year in which the assessment year ends. For mill or tunnel sites, a separate notice of intent to hold must be filed with the BLM on or before December 30. Requirements for filing a notice of intent to hold can be found at 43 CFR 3835.33.
9. A processing fee of \$10 for each claim listed must be remitted to the BLM along with this or any other affidavit of assessment work.

(Continued on page 4)

RECEIVED
STATE OFFICE
AUG 23 11 52
TUCSON, ARIZONA

Gary Haley
Phone #(520) 648-2040

Connie & Gary Haley
PO Box 584
Green Valley, AZ 85622



1006



85004

U.S. POSTAGE
PAID
SAHUARITA, AZ
85629
AUG 21, 17
AMOUNT
\$6.65
R2304H109228-07

Expected Delivery Day: 08/23/2017

USPS TRACKING NUMBER



9505 5123 7573 7233 1981 37

UNITED STATES
DEPARTMENT OF INTERIOR
Bureau of Land Management
Arizona State Office
One North Central Avenue, Suite 800
Phoenix, Arizona 85004-4427



PHOENIX ARIZONA

2017 AUG 23 A 1:51

RECEIVED
BLM
DEPT OF
INTERIOR

United States Department of the Interior
Bureau of Land Management
 DIV OF LANDS, MINRLS & ENERGY
 ONE N CENTRAL AVE
 PHOENIX, AZ 85004 -4427
 Phone: 602-417-9200

Receipt

No: 3954860

Transaction #: 4064624	
Date of Transaction: 08/24/2017	
CUSTOMER:	
CONNIE HALEY PO BOX 584 GREEN VALLEY, AZ 85622 US	

LINE #	QTY	DESCRIPTION	REMARKS	UNIT PRICE	TOTAL
1	1.00	LOCATABLE MINERALS / MINING CLAIMS- NOT NEW-UNADJUD, ONE AUTH NO. ONLY / MINING CLAIM MONEY RECEIVED CASES: AMC418628/\$60.00	MAINT 2018/6 WAV	- n/a -	60.00
TOTAL:					\$60.00

PAYMENT INFORMATION			
1	AMOUNT:	60.00	POSTMARKED: 08/21/2017
	TYPE:	CHECK	RECEIVED: 08/23/2017
	CHECK NO:	1320	
	NAME:	HALEY, CONNIE L PO BOX 584 GREEN VALLEY AZ 85622 US	

REMARKS

This receipt was generated by the automated BLM Collections and Billing System and is a paper representation of a portion of the official electronic record contained therein.

UNITED STATES
DEPARTMENT OF THE INTERIOR
BUREAU OF LAND MANAGEMENT

FORM APPROVED 418628
OMB NO.: 1004-0114
Expires: October 31, 2016
421122
421116

AFFIDAVIT OF ANNUAL ASSESSMENT WORK

423064
423063
423704

WHEN RECORDED, MAIL DOCUMENT TO:

NAME: Gary + Connie Haley
ADDRESS: PO Box 584
CITY, STATE, ZIP: Green Valley, AZ 85622

FOR COUNTY RECORDER'S USE

No. of Claims 6
x \$10/claim
Total due BLM \$ 60.00

TO ALL WHOM IT MAY CONCERN:

- The undersigned certifies that at least \$100 per claim was expended for development, labor and improvements, or equivalent value added, as the annual assessment work for the assessment year ending September 1, 2016 for the following contiguous unpatented mining claim(s), located in the County of Pima, in the State of Arizona.

BLM Serial No.	Name of Claim	Tp	Rg	Sec	Mer	County Recordation Book and Page No.	Date
418628	Peachie	17 S	12 E	003	Gila & S	20123130204 page 3	11/08/2012
421122	Buzzards End	17 S	10 E	026	Gila & S	20130590127 page 2	2/28/2013
421116	Apache Moon	17 S	10 E	026	Gila & S	20130590128 page 2	2/28/2013
423064	Apache Moon 2	17 S	10 E	026	Gila & S	20131420840 page 3	5/22/2013
423063	Honeycomb	17 S	10 E	026	Gila & S	20131420839 page 3	5/22/2013
423704	Skid Mark	17 S	10 E	026	Gila & S	20132050174 page 2	7/24/2013

RECEIVED
BLM AZ STATE OFFICE
PHOENIX, ARIZONA
AUG 25 P 2:18

(Continued on page 2)

AUG 29 2016
BY: R am

RECEIPT # 3642474

2. Type of labor and improvements (specify what was done and give the total value for that labor and improvement to show at least \$100 for each claim). If a geological, geochemical, or geophysical survey was performed, as per 30 U.S.C. 28-1, reference the title of the report of survey, give cost and date of the survey and report, and indicate it was filed with the County Recorder:

Description of Work Performed	Value of Work Performed	Date Work Was Performed
Improved roads, removed trash, cut brush	\$ 250.	March, 14, 15
Checked + fixed claim markers, cleared brush, trash	\$ 150.	March, 21, 15
leveled roads, removed rock	\$ 400.	April, 11, 15
fixed potholes, Trash removal	\$ 250.	May, 9, 15
Removed brush, filled potholes for access.	\$ 200.	May, 23, 15

3. Name and mailing address of each person who performed the labor and improvements:

Name (please print)
Gary Haley
Connie Haley

Current Mailing Address (please print)
PO Box 584, Green Valley, AZ 85622
PO Box 584, Green Valley, AZ 85622

4. Name and mailing address of each person who holds and claims the subject mining claim(s) for the valuable minerals contained therein. Be sure to indicate if there is a change of address:

Name (please print)
Gary Haley
Connie Haley

Current Mailing Address (please print)
PO Box 584, Green Valley 85622
PO Box 584, Green Valley 85622

RECEIVED
 BLM AZ STATE OFFICE
 2016 AUG 25 P 2:18
 PHOENIX, ARIZONA

5. The undersigned testifies that on the date of August, 23, 2016, all monuments required by law were erected upon the subject claim(s), and all notices required by law were posted on the subject claim(s) or copies thereof were in place, and at said date, each corner monument bore or contained

~~2018~~ AUG 25 P 2:18

PHOENIX, ARIZONA

markings sufficient to appropriately designate the corner of the claim to which it pertains and the name of the claim(s).

I hereby certify under penalty of perjury under the laws of the State of Arizona that the foregoing statements are true and correct:

X Cornelia Haley Mary Haley Date: X 8-23-2016
(Signature of person responsible for above statement)

Title 18 U.S.C. 1001 and 43 U.S.C. 1212 make it a crime for any person knowingly and willfully to make to any department or agency of the United States any false, fictitious or fraudulent statements or representations as to any matter within its jurisdiction.

Notary Block

SUBSCRIBED AND SWORN TO before me, this 23rd day of August 202016

By: [Signature]
(Signature of Affiant)

Title: Branch Mgr

My Commission Expires: 1-2-2020

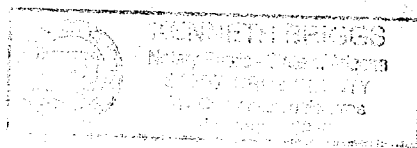

INSTRUCTIONS

1. This is an optional form that may be used to satisfy the requirements for the Bureau of Land Management (BLM) under the provisions of 43 U.S.C. §1744 and 30 U.S.C. §28-28d and the regulations thereunder (43 CFR part 3835). Since local and State laws may vary, you should contact your local and State agencies where the claims are located to ensure all applicable laws and requirements are satisfied.
2. The claimant(s) must fill in the date in paragraph 1 for the applicable assessment year and the county and state where the claims are located.
3. All claim names, BLM serial numbers, legal descriptions, and original county recording information must be listed for the claims pertaining to this assessment notice.
4. The claimant(s) must complete paragraph 2 listing all labor or improvements which was performed on or did benefit the subject mining claims. The value and date of the labor or improvements must also be listed. The total amount of labor or improvements can be listed, but the total expenditure must equal at least \$100 for each claim.
5. The names and current mailing addresses of the person(s) performing the labor shall be listed in paragraph 3.
6. The name and current mailing address of each owner (claimant) of the claims shall be listed in paragraph 4. The mailing address shall be the owner's address and not the address of an agent or anyone representing the claimant. Be sure to note if there has been a change of address.
7. Paragraph 5 shall be completed to show the date it was verified that all monuments required by law were properly erected, all notices were posted, and that corners were appropriately designated for all claims listed.
8. An exact legible reproduction or duplicate (other than microfilm or other electronic media) of this affidavit or another type of affidavit of assessment work that you file or will file in the county where each claim is located, must be filed with the BLM on or before December 30 of the calendar year in which the assessment year ends. For mill or tunnel sites, a separate notice of intent to hold must be filed with the BLM on or before December 30. Requirements for filing a notice of intent to hold can be found at 43 CFR 3835.33.
9. A processing fee of \$10 for each claim listed must be remitted to the BLM along with this or any other affidavit of assessment work.

NOTICE OF INTENTION TO HOLD MINING CLAIMS/SITES

When Recorded Return Document to:

Gary + Connie Haley
PO Box 584
Green Valley, AZ 85622

BLM
Date
Stamp

RECEIVED
BLM AZ STATE OFFICE
2016 AUG 25 P 2:18
PHOENIX, ARIZONA

8/30/16
8:33A - I called and
left a msg.

Check here if this is a change of address.

Telephone: (520) 648-2040

E-mail Address: adamsplace773@peoplepc.com

I (We) intend to hold the claims(s) and/or site(s) listed below for the calendar year 2017, and I (We) have filed or will file a Notice of Intent to Hold in the county where the claim (s) is located.

Reason for filing a Notice of Intent to Hold instead of an assessment work filing (check one):

- Maintenance fee was paid to maintain claim(s) during this assessment year.
- Mill or tunnel sites.
- Claim(s) was located during the current assessment year.
- BLM has deferred assessment work (attach copy of decision granting deferment, or pending petition for deferment including date petition was filed.)

Line No.	AMC NUMBER	CLAIM/SITE NAME	COUNTY RECORDER DATA (if available)	TWP	RNG	SEC
1	418628	Peachie	20123130204	17S	12E	003
2	421122	Buzzards End	20130590127	17S	10E	026
3	421116	Apache Moon	20130590128	17S	10E	026
4	423064	Apache Moon 2	20131420840	17S	10E	026
5	423063	Honey Comb	20131420839	17S	10E	026
6	423704	Skid Mark	20132050174	17S	10E	026
7						
8						
9						
10						

Form: MCF110
Revised July 2014

Page 1 of 2

This NOI Form is OPTIONAL; the above claims have been under a Waiver since 2015. PB

1/30/16 (3:14pm) Mr. Haley called - stated if the NOI is not necessary, please disregard it, he will send his request via EMAIL as well. PB
 Email msg Rec'd on 8/30/16 @ 3:43pm (Attached).

NOTICE OF INTENTION TO HOLD MINING CLAIMS/SITES
page 2

RECEIVED
BLM AZ STATE OFFICE
2016 AUG 25 P 2:18
PHOENIX, ARIZONA
BLM
Date
Stamp

1. State of Arizona, County of Pima

2. I (Name) Connie Haley, Gary Haley

3. Reside at (Address) 16621 Horse Hollow Trail

City Sahuarita County Pima State AZ Zip 85629 being duly sworn, depose and say that I am a citizen of the United States, more than eighteen years of age, that all of the facts set forth in this notice, subject to the provisions and penalties of 18 U.S.C. 1001 pertaining to the filing of false, fictitious, or fraudulent statements with the United States, are true and correct according to the best of my knowledge, information and belief.

4. Owner's name and address (If not shown in Items 1-3 above). Connie Haley + Gary Haley

5. Dated: 8/23/2016 Signature: Connie L. Haley, Gary Haley

Bureau of Land Management
Arizona State Office
www.blm.gov/az

No. of Claims: _____ x \$10 = _____
Check No: _____ Init. _____
Receipt No.: _____
For BLM Use Only



Brown, Pauline <paulinebrown@blm.gov>

AMC418628, ET AL

1 message

Brown, Pauline <paulinebrown@blm.gov>
To: adamsplace773@peoplec.com

Tue, Aug 30, 2016 at 9:39 AM

To Gary and Connie Haley,

On August 25, 2016, this office received a payment for \$60 (Receipt #3642474); with the payment, you submitted a Notice of intention (NOI) to hold mining claims form (Form: MCF110) and the Affidavit of annual assessment work (POL) form (Form 3830-4).

For your information, the \$60 payment was applied towards the assessment work on the 6 claims you listed on the POL form. The NOI form is 'optional' at this time because you have been filing a waiver on the same 6 claims since 2015.

If you still want us to process the NOI form, you will need to send in an additional \$60 because the fee to process the NOI is \$10 per mining claim. If you have any questions please feel free to call.

Regards,

PAULINE BROWN
LAND LAW EXAMINER
BUREAU OF LAND MANAGEMENT
ARIZONA STATE OFFICE
ONE NORTH CENTRAL AVE, STE 800
PHOENIX, AZ 85004-4427
OFFICE: (602) 417-9360
FAX: (602) 417-9490; 602-417-9452
paulinebrown@blm.gov
www.blm.gov/az
<https://www.facebook.com/BLMArizona>



Connie Agency
 PO Box 584
 Green Valley, AZ 85622-0584



7015 3430 0001 0100 1387



1000



85004

U.S. POSTAGE
 PAID
 GREEN VALLEY, AZ
 85614

AUG 23 16

AMOUNT
\$4.45

R2303S101109-13

RECEIVED
 BLM AZ STATE OFFICE
 2016 AUG 25 P 2:17
 PHOENIX, ARIZONA

UNITED STATES
DEPARTMENT OF INTERIOR
Bureau of Land Management
Arizona State Office
One North Central Avenue, Suite 800
Phoenix, Arizona 85004-4427

Customer Name Update Screen

System ID:MC

Name:

Proprietor #: Renumber To:

Category:

Address:

City:

State:

Zip:
 UNDELIVERABLE

Email:

Phone:

10/10/2016 10:00 AM

ENTERED AUG 30 2016

*Email / ph
fb*

Customer details successfully saved for Customer Id 2336331

Customer Name Update Screen

System ID:MC

Name:

Proprietor #: Renumber To:

Category:

Address:

City:

State:

Zip:
 UNDELIVERABLE

Email:

Phone:

ENTERED AUG 30 2016

PB

Customer details successfully saved for Customer Id 2336330

United States Department of the Interior
Bureau of Land Management
 DIV OF LANDS, MINRLS & ENERGY
 ONE N CENTRAL AVE
 PHOENIX, AZ 85004 -4427
 Phone: 602-417-9200

Receipt

No: 3642474

Transaction #: 3746430	
Date of Transaction: 08/26/2016	
CUSTOMER:	
CONNIE HALEY PO BOX 584 GREEN VALLEY, AZ 85622 US	

LINE #	QTY	DESCRIPTION	REMARKS	UNIT PRICE	TOTAL
1	1.00	LOCATABLE MINERALS / MINING CLAIMS- NOT NEW-UNADJUD, ONE AUTH NO. ONLY / MINING CLAIM MONEY RECEIVED CASES: AMC418628/\$60.00	NOI/POL 2016 - 6 <i>optional</i>	- n/a -	60.00
TOTAL:					\$60.00

PAYMENT INFORMATION					
1	AMOUNT:	60.00	POSTMARKED:	08/23/2016	
	TYPE:	CHECK	RECEIVED:	08/25/2016	
	CHECK NO:	1136			
	NAME:	HALEY, CONNIE L PO BOX 584 GREEN VALLEY AZ 85622 US			

REMARKS

This receipt was generated by the automated BLM Collections and Billing System and is a paper representation of a portion of the official electronic record contained therein.



AMC418628, ET AL

4 messages

Brown, Pauline <paulinebrown@blm.gov>
To: adamsplace773@peoplec.com

Tue, Aug 30, 2016 at 9:39 AM

To Gary and Connie Haley,

On August 25, 2016, this office received a payment for \$60 (Receipt #3642474); with the payment, you submitted a Notice of interntion (NOI) to hold mining claims form (Form: MCF110) and the Affidavit of annual assessment work (POL) form (Form 3830-4).

For your information, the \$60 payment was applied towards the assessment work on the 6 claims you listed on the POL form. The NOI form is 'optional' at this time because you have been filing a waiver on the same 6 claims since 2015.

If you still want us to process the NOI form, you will need to send in an additional \$60 because the fee to process the NOI is \$10 per mining claim. If you have any questions please feel free to call.

Regards,

—
PAULINE BROWN
LAND LAW EXAMINER
BUREAU OF LAND MANAGEMENT
ARIZONA STATE OFFICE
ONE NORTH CENTRAL AVE, STE 800
PHOENIX, AZ 85004-4427
OFFICE: (602) 417-9360
FAX: (602) 417-9490; 602-417-9452
paulinebrown@blm.gov
www.blm.gov/az
<https://www.facebook.com/BLMArizona>

Brown, Pauline <paulinebrown@blm.gov>
To: adamsplace773@peoplepc.com

Tue, Aug 30, 2016 at 3:27 PM

Sorry, I forgot the p in the message sent today at 9:39am.
Thank you for returning my call.

Regards,

— Forwarded message —
From: **Brown, Pauline** <paulinebrown@blm.gov>
Date: Tue, Aug 30, 2016 at 9:39 AM
Subject: AMC418628, ET AL
To: adamsplace773@peoplec.com

To Gary and Connie Haley,

On August 25, 2016, this office received a payment for \$60 (Receipt #3642474); with the payment, you submitted a Notice of interntion (NOI) to hold mining claims form (Form: MCF110) and the Affidavit of annual assessment work (POL) form (Form 3830-4).

For your information, the \$60 payment was applied towards the assessment work on the 6 claims you listed on the POL form. The NOI form is 'optional' at this time because you have been filing a waiver on the same 6 claims since 2015.

If you still want us to process the NOI form, you will need to send in an additional \$60 because the fee to process the NOI is \$10 per mining claim. If you have any questions please feel free to call.

Regards,

—
PAULINE BROWN
LAND LAW EXAMINER
BUREAU OF LAND MANAGEMENT
ARIZONA STATE OFFICE
ONE NORTH CENTRAL AVE, STE 800
PHOENIX, AZ 85004-4427
OFFICE: (602) 417-9360
FAX: (602) 417-9490; 602-417-9452
paulinebrown@blm.gov
www.blm.gov/az
<https://www.facebook.com/BLMArizona>

—
PAULINE BROWN
LAND LAW EXAMINER
BUREAU OF LAND MANAGEMENT
ARIZONA STATE OFFICE
ONE NORTH CENTRAL AVE, STE 800
PHOENIX, AZ 85004-4427
OFFICE: (602) 417-9360
FAX: (602) 417-9490; 602-417-9452
paulinebrown@blm.gov
www.blm.gov/az
<https://www.facebook.com/BLMArizona>

Sender A <adamsplace773@peoplepc.com>
Reply-To: **Sender A** <adamsplace773@peoplepc.com>
To: "Brown, Pauline" <paulinebrown@blm.gov>

Tue, Aug 30, 2016 at 3:36 PM

Dear Pauline Brown,

I'm writing to confirm please DO NOT process the "Notice Of Intent form" that was incorrectly added with Affidavit of assessment work forms.

Thank you for all your assistance, Gary Haley

—Original Message—

From: "Brown, Pauline"
Sent: Aug 30, 2016 3:27 PM
To: adamsplace773@peoplepc.com
Subject: Fwd: AMC418628, ET AL

Sorry, I forgot the p in the message sent today at 9:39am.
Thank you for returning my call.

Regards,

— Forwarded message —
From: **Brown, Pauline** <paulinebrown@blm.gov>
Date: Tue, Aug 30, 2016 at 9:39 AM
Subject: AMC418628, ET AL
To: adamsplace773@peoplepc.com

To Gary and Connie Haley,

On August 25, 2016, this office received a payment for \$60 (Receipt #3642474); with the payment, you submitted a Notice of intention (NOI) to hold mining claims form (Form: MCF110) and the Affidavit of annual assessment work (POL) form (Form 3830-4).

For your information, the \$60 payment was applied towards the assessment work on the 6 claims you listed on the POL form. The NOI form is 'optional' at this time because you have been filing a waiver on the same 6 claims since 2015.

If you still want us to process the NOI form, you will need to send in an additional \$60 because the fee to process the NOI is \$10 per mining claim. If you have any questions please feel free to call.

Regards,

—
PAULINE BROWN
LAND LAW EXAMINER
BUREAU OF LAND MANAGEMENT
ARIZONA STATE OFFICE
ONE NORTH CENTRAL AVE, STE 800
PHOENIX, AZ 85004-4427
OFFICE: (602) 417-9360
FAX: (602) 417-9490; 602-417-9452
paulinebrown@blm.gov
www.blm.gov/az
<https://www.facebook.com/BLMArizona>

—
PAULINE BROWN
LAND LAW EXAMINER
BUREAU OF LAND MANAGEMENT
ARIZONA STATE OFFICE
ONE NORTH CENTRAL AVE, STE 800
PHOENIX, AZ 85004-4427
OFFICE: (602) 417-9360
FAX: (602) 417-9490; 602-417-9452
paulinebrown@blm.gov
www.blm.gov/az
<https://www.facebook.com/BLMArizona>

Brown, Pauline <paulinebrown@blm.gov>
To: Sender A <adamsplace773@peoplepc.com>

Tue, Aug 30, 2016 at 3:43 PM

Yes Sir, thank you for responding to my email message, I will attach this message to your packet to be filed.

Take care,

On Tue, Aug 30, 2016 at 3:36 PM, Sender A <adamsplace773@peoplepc.com> wrote:
Dear Pauline Brown,

I'm writing to confirm please DO NOT process the "Notice Of Intent form" that was incorrectly added with Affidavit of assessment work forms.

Thank you for all your assistance, Gary Haley

—Original Message—

From: "Brown, Pauline"
Sent: Aug 30, 2016 3:27 PM
To: adamsplace773@peoplepc.com
Subject: Fwd: AMC418628, ET AL

Sorry, I forgot the p in the message sent today at 9:39am.
Thank you for returning my call.

Regards,

— Forwarded message —
From: **Brown, Pauline** <paulinebrown@blm.gov>

NOI Form X'd out
8/30/16
PB

Date: Tue, Aug 30, 2016 at 9:39 AM
Subject: AMC418628, ET AL
To: adamsplace773@peoplec.com

To Gary and Connie Haley,

On August 25, 2016, this office received a payment for \$60 (Receipt #3642474); with the payment, you submitted a Notice of intertion (NOI) to hold mining claims form (Form: MCF110) and the Affidavit of annual assessment work (POL) form (Form 3830-4).

For your information, the \$60 payment was applied towards the assessment work on the 6 claims you listed on the POL form. The NOI form is 'optional' at this time because you have been filing a waiver on the same 6 claims since 2015.

If you still want us to process the NOI form, you will need to send in an additional \$60 because the fee to process the NOI is \$10 per mining claim. If you have any questions please feel free to call.

Regards,

—
PAULINE BROWN
LAND LAW EXAMINER
BUREAU OF LAND MANAGEMENT
ARIZONA STATE OFFICE
ONE NORTH CENTRAL AVE, STE 800
PHOENIX, AZ 85004-4427
OFFICE: (602) 417-9360
FAX: (602) 417-9490; 602-417-9452
paulinebrown@blm.gov
www.blm.gov/az
<https://www.facebook.com/BLMArizona>

—
PAULINE BROWN
LAND LAW EXAMINER
BUREAU OF LAND MANAGEMENT
ARIZONA STATE OFFICE
ONE NORTH CENTRAL AVE, STE 800
PHOENIX, AZ 85004-4427
OFFICE: (602) 417-9360
FAX: (602) 417-9490; 602-417-9452
paulinebrown@blm.gov
www.blm.gov/az
<https://www.facebook.com/BLMArizona>

—
PAULINE BROWN
LAND LAW EXAMINER
BUREAU OF LAND MANAGEMENT
ARIZONA STATE OFFICE
ONE NORTH CENTRAL AVE, STE 800
PHOENIX, AZ 85004-4427
OFFICE: (602) 417-9360
FAX: (602) 417-9490; 602-417-9452
paulinebrown@blm.gov
www.blm.gov/az
<https://www.facebook.com/BLMArizona>

DEPARTMENT OF THE INTERIOR
BUREAU OF LAND MANAGEMENT
MINING CLAIMSMC Customer Information - With Serial No. and Last Assessment Code
ACTIVE CLAIMS

Admin State: AZ

Geo State: AZ

HALEY GARY
PO BOX 584
GREEN VALLEY, AZ 85622-0584

CUSTOMER ID: 2336330

<u>Serial No.</u>	<u>Claim Name/Number</u>	<u>Last Assmt Code</u>	<u>Last Assmt YR</u>	<u>Disposition</u>
AMC418628	PEACHIE	483	2016	ACTIVE
AMC421116	APACHE MOON	483	2016	ACTIVE
AMC421122	BUZZARDS END	483	2016	ACTIVE
AMC423063	HONEY COMB	483	2016	ACTIVE
AMC423064	APACHE MOON 2	483	2016	ACTIVE
AMC423704	SKID MARK	483	2016	ACTIVE

Number of ACTIVE cases: 6

UNITED STATES
DEPARTMENT OF THE INTERIOR
BUREAU OF LAND MANAGEMENT

421

418628 423063
421116 423064
421122 423704
FORM APPROVED
OMB NO. 1004-0114
Expires: October 31, 2016

MAINTENANCE FEE WAIVER CERTIFICATION

SEE INSTRUCTIONS ON PAGE 2

1. This small miner waiver is filed for the assessment year beginning on September 1, 2015^{to} and ending on September 1, 2016^{to}.
2. The undersigned and all related parties owned ten or fewer mining claims, mill, or tunnel sites located and maintained on Federal lands in the United States of America on September 1, 2016.
3. The undersigned have performed the assessment work required by law for each mining claim listed prior to filing this waiver and understand that by filing this form, the undersigned must file an affidavit of assessment work with the Bureau of Land Management (BLM) by the December 30th following the filing of this waiver.
4. The undersigned understand that if the assessment work obligation has not yet come due under 30 U.S.C. 28 (for those claims in their first assessment year only), a notice of intent to hold reciting this condition must be recorded by the December 30th following the filing of this waiver.
5. The undersigned understand that mill and tunnel sites may also be listed on this waiver and be waived from payment of the maintenance fee, and that a notice of intent to hold for these sites is required to be filed with the BLM by the December 30th following the filing of this waiver.
6. The undersigned understand and acknowledge that pursuant to 43 U.S.C. 1212 and 18 U.S.C. 1001, the filing or recording of a false, fictitious, or fraudulent document with the BLM may result in a fine of up to \$250,000, a prison term not to exceed five years, or both.
7. The mining claims, mill or tunnel sites for which this waiver from payment of the maintenance fees is requested are:

CLAIM OR SITE NAME	BLM RECORDATION SERIAL NUMBER
1. PEACHIE	418628 ✓
2. BUZZARDS END	421122
3. APACHE MOON	421116
4. APACHE MOON 2	423064
5. HONEYCOMB	423063
6. SKID MARK	423704
7.	
8.	
9.	
10.	

RECEIVED
BLM AZ STATE OFFICE
2016 AUG 25 P 2:18
PHOENIX, ARIZONA

The owner(s) (claimants) of the above mining claims and sites are:

Connie Haley

(Owner's Name - Please Print)

X Connie L. Haley

(Owner's Signature)

PO Box 584, Green Valley, AZ 85622

(Owner's Mailing Address)

Green Valley

(City)

AZ

(State)

85622

(Zip Code)

Gary Haley

(Owner's Name - Please Print)

X Gary Haley

(Owner's Signature)

PO Box 584, Green Valley, AZ 85622

(Owner's Mailing Address)

Green Valley

(City)

AZ

(State)

85622

(Zip Code)

(Owner's Name - Please Print)

(Owner's Signature)

(Owner's Mailing Address)

(City)

(State)

(Zip Code)

(Owner's Name - Please Print)

(Owner's Signature)

(Owner's Mailing Address)

(City)

(State)

(Zip Code)

(Continued on page 2)

Gary Haley
Phone # (520) 648-2040

ENTERED
493
SEP 07 2016
BY: [Signature]

[Handwritten initials]

Connie Haley
(Owner's Name - Please Print)

X *Connie L. Haley*
(Owner's Signature)

PO Box 584
(Owner's Mailing Address)

Green Valley AZ 85622
(City) (State) (Zip Code)

Gary Haley
(Owner's Name - Please Print)

X *Gary Haley*
(Owner's Signature)

PO Box 584
(Owner's Mailing Address)

Green Valley AZ 85622
(City) (State) (Zip Code)

(Owner's Name - Please Print)

(Owner's Signature)

(Owner's Mailing Address)

(City) (State) (Zip Code)

(Owner's Name - Please Print)

(Owner's Signature)

(Owner's Mailing Address)

(City) (State) (Zip Code)

18 U.S.C. 1001 and 43 U.S.C. 1212 make it a crime for any person knowingly and willfully to make to any department or agency of the United States any false, fictitious or fraudulent statements or representations as to any matter within its jurisdiction.

INSTRUCTIONS

1. This certification is made under the provisions of 43 U.S.C. § 1744 and 30 U.S.C. §28-28k and the regulations thereunder (43 CFR Part 3830).
2. The claimant(s) must fill in the dates in paragraph 1 for the beginning and ending of the assessment year for which this waiver is sought.
3. The claimant(s) must fill in the date in paragraph 2 for the beginning of the assessment year for which this waiver is sought.
4. All claim and site names and BLM serial numbers must be listed for the mining claims, mill sites, and tunnel sites for which the waiver is sought.
5. All owners of the mining claims, mill sites, and tunnel sites and their addresses must be given.
6. This waiver form must be signed by all the claimants or their designated agent, in original form. If an agent is designated, a notarized designation of agent, signed by all of the claimants with proper address given, must be submitted with this waiver.
7. This form must be filed no later than September 1st for the upcoming assessment year in the BLM State Office where the mining claims or sites are recorded, or the waiver cannot be granted by the BLM. (Example: To obtain a waiver for the assessment year 2012, which begins on September 1, 2011, you must qualify for and file for a waiver no later than September 1, 2011, in the proper BLM State Office.)
8. For all mining claims which require assessment work, you must record an affidavit of labor on or before the December 30th immediately following the filing of this waiver. For all other mining claims or sites waived, you must record a notice of intent to hold on or before the December 30th immediately following the filing of this waiver.
9. Mill and tunnel sites may also be listed on this waiver and be waived from payment of the maintenance fee. A notice of intent to hold for these sites is required to be filed by the December 30th following the filing of this waiver.

RECEIVED
BLM AZ STATE OFFICE
2011 AUG 25 P 2:19
PHOENIX, ARIZONA

FOR OFFICIAL USE ONLY

Gary Haley
Phone# (520) 648-2040

UNITED STATES
DEPARTMENT OF THE INTERIOR
BUREAU OF LAND MANAGEMENT

488

418628 423064
421116 423704
421122
423063

FORM APPROVED
OMB NO. 1004-0114
Expires: October 31, 2016

MAINTENANCE FEE WAIVER CERTIFICATION

AA

SEE INSTRUCTIONS ON PAGE 2

- This small miner waiver is filed for the assessment year beginning on September 1, ~~2014~~²⁰¹⁵ and ending on September 1, ~~2015~~²⁰¹⁶.
- The undersigned and all related parties owned ten or fewer mining claims, mill, or tunnel sites located and maintained on Federal lands in the United States of America on September 1, 2015.
- The undersigned have performed the assessment work required by law for each mining claim listed prior to filing this waiver and understand that by filing this form, the undersigned must file an affidavit of assessment work with the Bureau of Land Management (BLM) by the December 30th following the filing of this waiver.
- The undersigned understand that if the assessment work obligation has not yet come due under 30 U.S.C. 28 (for those claims in their first assessment year only), a notice of intent to hold reciting this condition must be recorded by the December 30th following the filing of this waiver.
- The undersigned understand that mill and tunnel sites may also be listed on this waiver and be waived from payment of the maintenance fee, and that a notice of intent to hold for these sites is required to be filed with the BLM by the December 30th following the filing of this waiver.
- The undersigned understand and acknowledge that pursuant to 43 U.S.C. 1212 and 18 U.S.C. 1091, the filing or recording of a false, fictitious, or fraudulent document with the BLM may result in a fine of up to \$250,000, a prison term not to exceed five years, or both.
- The mining claims, mill or tunnel sites for which this waiver from payment of the maintenance fees is requested are:

CLAIM OR SITE NAME	BLM RECORDATION SERIAL NUMBER
1. Peachie	418628 ✓
2. Buzzards End	421122
3. Apache Moon	421116
4. Apache Moon 2	423064
5. Honeycomb	423063
6. Skid Mark	423704
7.	
8.	
9.	
10.	

RECEIVED
BLM AZ PHOENIX OFFICE
2015 AUG 26 P 3:00
PHOENIX, ARIZONA

The owner(s) (claimants) of the above mining claims and sites are:

Gary Haley
(Owner's Name - Please Print)

PO Box 584, Green Valley, AZ 85622
(Owner's Mailing Address)

Green Valley AZ 85622
(City) (State) (Zip Code)

Gary Haley
(Owner's Signature)

Connie Haley
(Owner's Name - Please Print)

PO Box 584, Green Valley, AZ 85622
(Owner's Mailing Address)

Green Valley AZ 85622
(City) (State) (Zip Code)

Connie Haley
(Owner's Signature)

(Owner's Name - Please Print)

(Owner's Mailing Address)

(City) (State) (Zip Code)

(Owner's Signature)

(Owner's Name - Please Print)

(Owner's Mailing Address)

(City) (State) (Zip Code)

(Owner's Signature)

INTEREST
SEP 11 2015
BY: *[Signature]*

(Continued on page 2)
Gary Haley
Phone # 520-648-2040

NWV
9/9/2015

Gary Haley

(Owner's Name - Please Print)

PO Box 584

(Owner's Mailing Address)

x Gary Haley

(Owner's Signature)

Green Valley

(City)

AZ

(State)

85622

(Zip Code)

Connie Haley

(Owner's Name - Please Print)

PO Box 584

(Owner's Mailing Address)

x Connie Lee Haley

(Owner's Signature)

Green Valley

(City)

AZ

(State)

85622

(Zip Code)

(Owner's Name - Please Print)

(Owner's Signature)

(Owner's Mailing Address)

(City)

(State)

(Zip Code)

(Owner's Name - Please Print)

(Owner's Signature)

(Owner's Mailing Address)

(City)

(State)

(Zip Code)

18 U.S.C. 1001 and 43 U.S.C. 1212 make it a crime for any person knowingly and willfully to make to any department or agency of the United States any false, fictitious or fraudulent statements or representations as to any matter within its jurisdiction.

PHOENIX, ARIZONA
2015 AUG 26 P 3:00
BLM 47000000
RECEIVED OFFICE

INSTRUCTIONS

1. This certification is made under the provisions of 43 U.S.C. § 1744 and 30 U.S.C. §28-28k and the regulations thereunder (43 CFR Part 3830).
2. The claimant(s) must fill in the dates in paragraph 1 for the beginning and ending of the assessment year for which this waiver is sought.
3. The claimant(s) must fill in the date in paragraph 2 for the beginning of the assessment year for which this waiver is sought.
4. All claim and site names and BLM serial numbers must be listed for the mining claims, mill sites, and tunnel sites for which the waiver is sought.
5. All owners of the mining claims, mill sites, and tunnel sites and their addresses must be given.
6. This waiver form must be signed by all the claimants or their designated agent, in original form. If an agent is designated, a notarized designation of agent, signed by all of the claimants with proper address given, must be submitted with this waiver.
7. This form must be filed no later than September 1st for the upcoming assessment year in the BLM State Office where the mining claims or sites are recorded, or the waiver cannot be granted by the BLM. (Example: To obtain a waiver for the assessment year 2012, which begins on September 1, 2011, you must qualify for and file for a waiver no later than September 1, 2011, in the proper BLM State Office.)
8. For all mining claims which require assessment work, you must record an affidavit of labor on or before the December 30th immediately following the filing of this waiver. For all other mining claims or sites waived, you must record a notice of intent to hold on or before the December 30th immediately following the filing of this waiver.
9. Mill and tunnel sites may also be listed on this waiver and be waived from payment of the maintenance fee. A notice of intent to hold for these sites is required to be filed by the December 30th following the filing of this waiver.

FOR OFFICIAL USE ONLY

When Recorded Return Document to:

418628
421116
421122
423063
423064
423704

Check here is this is a change of address.

Telephone: _____

E-mail address: _____

AFFIDAVIT OF PERFORMANCE OF ANNUAL WORK

- 1. State of Arizona, County of Pima ss:
- 2. I (Name) Connie Haley + Gary Haley
- 3. Reside at (Address) PO Box 584

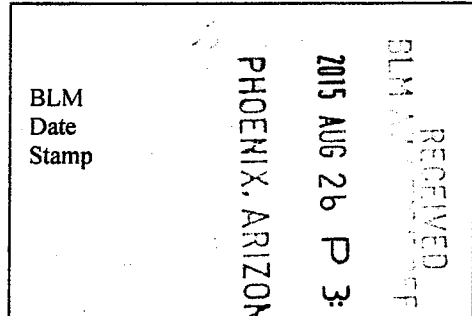

City Green Valley County Pima

State AZ zip 85622 being duly sworn, depose and say that I am a citizen of the United States, more than eighteen years of age, and that all of the facts set forth in this affidavit, subject to the provisions and penalties of 18 U.S.C. 1001 pertaining to the filing of false, fictitious, or fraudulent statements with the United States, are true and correct according to the best of my knowledge, information and belief.

4. Owner's name and address (If not shown in Items 1-3 above).
Connie Haley, Gary Haley, PO BOX 584, Green Valley, AZ 85622

5. That I am personally acquainted with the mining claim(s). The work and improvements were made by and at the expense of the owner(s) of said claim(s). Said contiguous group of claims, listed on this document, are situated in the Gila & Salt River (optional) Mining District; Pima County, Arizona.

Line No.	AMC NUMBER	CLAIM/SITE NAME	COUNTY RECORDER DATA (If available)	TWP	RNG	SEC
1	418628	Peachie	20123130204	17S	12E	003
2	421122	Buzzards End	20130590127	17S	10E	026
3	421116	Apache Moon	20130590128	17S	10E	026
4	423064	Apache Moon 2	20131420840	17S	10E	026
5	423063	Honeycomb	20131420839	17S	10E	026
6	423704	Skid Mark	20132050174	17S	10E	026

Form: MCF108
Revised July 2014
Page 1 of 2

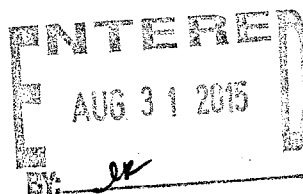

Gary Haley

Phone # 520-648-2040

BLM
Date
Stamp

2015 AUG 26 P 3 01
PHOENIX, ARIZONA

RECEIVED
PIMA COUNTY OFFICE

7					
8					
9					
10					

6. That between the dates starting at 12 o'clock noon on September 1, 20 14 and ending at 12 o'clock noon on September 1, 20 15 at least \$ 1,100. dollars worth of work and improvements were done and performed upon said claim(s) or upon one or more of a contiguous group of claims for the benefit of all, wholly or partly outside of a contiguous group of claims for the benefit of all, not including the location work.

7. That the following persons were employed to perform the work and improvements described herein: _____

Gary Haley, Connie Haley

8. That the work and improvements performed were: Repaired roads, cut Brush, leveled dips, Fixed claim markers, filled in washed out spots.

9. Dated: 8-18-15 Signature: Gary Haley, Connie Haley

SUBSCRIBED AND SWORN TO before me, a Notary Public, this 18 day of August 20 15

By: Gary Haley & Connie Haley

Notary Public [Signature]

My Commission Expires 05/18/18 05/04/18

Bureau of Land Management
Arizona State Office
www.blm.gov/az

No. of Claims: 60 x \$10 = \$600.00
Check No.: 0965 Init. [Initials]
Receipt No.: 3378653
For BLM Use Only

 Natalie Mazon
Notary Public
Pima County, Arizona
My Comm. Expires 05-04-18

Form: MCF108
Revised July 2014
Page 2 of 2

NOTICE OF INTENTION TO HOLD MINING CLAIMS/SITES

When Recorded Return Document to:

Check here if this is a change of address.
 Telephone: _____
 E-mail Address: _____

BLM
 Date
 Stamp

2015 AUG 26 P 3:00
 PHOENIX, ARIZONA

RECEIVED

I (We) intend to hold the claims(s) and/or site(s) listed below for the calendar year 2015, and I (We) have filed or will file a Notice of Intent to Hold in the county where the claim (s) is located.

Reason for filing a Notice of Intent to Hold instead of an assessment work filing (check one):

- Maintenance fee was paid to maintain claim(s) during this assessment year.
- Mill or tunnel sites.
- Claim(s) was located during the current assessment year.
- BLM has deferred assessment work (attach copy of decision granting deferment, or pending petition for deferment including date petition was filed.)

Line No.	AMC NUMBER	CLAIM/SITE NAME	COUNTY RECORDER DATA (if available)	TWP	RNG	SEC
1	418628	Peachie	20123130204	17S	12E	003
2	421122	Buzzards End	20130590127	17S	10E	026
3	421116	Apache Moon	20130590128	17S	10E	026
4	423064	Apache Moon 2	20131420840	17S	10E	026
5	423063	Honeycomb	20131420839	17S	10E	026
6	423704	Skid Mark	20132050174	17S	10E	026
7						
8						
9						
10						

Gary Haley
 Phone # 520-648-2040

NOTICE OF INTENTION TO HOLD MINING CLAIMS/SITES
page 2

BLM
Date
Stamp

2015 AUG 26 P 3:00
PHOENIX, ARIZONA

BLM RECEIVED OFFICE

1. State of Arizona, County of Pima

2. I (Name) Connie Haley, Gary Haley

3. Reside at (Address) 16621 Horse Hollow Trail

City Sahuarita County Pima State AZ Zip 85629 being duly sworn, depose and say that I am a citizen of the United States, more than eighteen years of age, that all of the facts set forth in this notice, subject to the provisions and penalties of 18 U.S.C. 1001 pertaining to the filing of false, fictitious, or fraudulent statements with the United States, are true and correct according to the best of my knowledge, information and belief.

4. Owner's name and address (If not shown in Items 1-3 above). Connie Haley, Gary Haley

5. Dated: _____ Signature: Connie L. Haley, Gary Haley

Bureau of Land Management
Arizona State Office
www.blm.gov/az

No. of Claims: _____ x \$10 = _____
Check No: _____ Init. _____
Receipt No.: _____
For BLM Use Only

Form: MCF110
Revised July 2014
Page 2 of 2

Connie & Gary Haley
PO Box 584
Green Valley, AZ 85622



7015 0640 0006 5034 0665



1000



85004

U.S. POSTAGE
PAID
GREEN VALLEY, AZ
85614
AUG 20, 15
AMOUNT
\$4.65
R2304M112169-1

RECEIVED
STATE OF
2015 AUG 26 P 3:00
PHOENIX, ARIZONA

**UNITED STATES
DEPARTMENT OF INTERIOR**
Bureau of Land Management
Arizona State Office
One North Central Avenue, Suite 800
Phoenix, Arizona 85004-4427

United States Department of the Interior
Bureau of Land Management
 LANDS/RECREATION & PLANNING
 ONE N CENTRAL AVE
 PHOENIX, AZ 85004 -2203
 Phone: 602-417-9200

Receipt

No: 3378653

Transaction #: 3476906	
Date of Transaction: 08/27/2015	
CUSTOMER:	
GARY L HALEY PO BOX 584 GREEN VALLEY, AZ 85622-0584 US	

LINE #	QTY	DESCRIPTION	REMARKS	UNIT PRICE	TOTAL
1	1.00	LOCATABLE MINERALS / MINING CLAIMS-NOT NEW-UNADJUD, ONE AUTH NO. ONLY / MINING CLAIM MONEY RECEIVED CASES: AMC418628/\$60.00	WAIVER - 6 2016 / POL - 6 2015 / NOI - 6 2015	- n/a -	60.00
TOTAL:					\$60.00

PAYMENT INFORMATION			
1	AMOUNT:	60.00	POSTMARKED: 08/20/2015
	TYPE:	CHECK	RECEIVED: 08/26/2015
	CHECK NO:	0965	
	NAME:	HALEY, GARY L PO BOX 584 GREEN VALLEY AZ 85622-0584 US	

REMARKS

This receipt was generated by the automated BLM Collections and Billing System and is a paper representation of a portion of the official electronic record contained therein.

ENTERED
 AUG 31 2015
 BY: jr

8/27/2015

UNITED STATES
DEPARTMENT OF THE INTERIOR
BUREAU OF LAND MANAGEMENT
**MAINTENANCE FEE PAYMENT FORM FOR
LODE CLAIMS, MILL SITES, AND TUNNEL SITES**

AMC 418628
AMC 421122
AMC 421116
AMC 423064
AMC 423063
AMC 423704

Remitter Name: Connie L. Haley - Mary Haley
Mailing Address: PO Box 584
City, State, Zip: Green Valley, AZ 85622

Check here if this is a change of address.

FOR COUNTY RECORDER'S USE

No. of claims/sites 6
x \$140 per claim/site
Total due BLM \$ 840.00

- The maintenance fee may be paid by cash, check, money order, Bureau of Land Management (BLM) Declining Deposit Account, or credit card (VISA, American Express, Discover, or MasterCard). Payments must be remitted to the BLM State Office where your claim or site is recorded and received on or before September 1. If the payment is mailed, the envelope must be postmarked by a bona fide delivery service on or before September 1 and received at the proper BLM State Office within 15 calendar days after the due date. Payments may also be made by telephone using a credit card. A complete listing of BLM State Offices with their addresses and phone numbers can be found at <http://www.blm.gov>.
- The maintenance fee for the following claim(s)/site(s) applies to the assessment year 2014.

CLAIM/SITE NAME	BLM SERIAL NO.
<u>Peachie</u>	<u>AMC 418628</u>
<u>Buzzards End</u>	<u>AMC 421122</u>
<u>Apache Moon</u>	<u>AMC 421116</u>
<u>* Apache Moon 2</u>	<u>AMC 423064</u>
<u>Honeycomb</u>	<u>AMC 423063</u>
<u>Skid Mark</u>	<u>AMC 423704</u>

Use a separate sheet for additional claim/site names, serial numbers, and claimant names and addresses.

(Continued on page 2)

Receipt # 12865545
CAH.

ENTERED
SEP 03 2013
BY: TS

RECEIVED
BLM AZ STATE OFFICE
PHOENIX, ARIZONA
2013 AUG 26 P 12:51

United States Department of the Interior
Bureau of Land Management
 LANDS/RECREATION & PLANNING
 ONE N CENTRAL AVE
 PHOENIX, AZ 85004 -2203
 Phone: 602-417-9200

Receipt

No: 2865545

Transaction #: 2951466	
Date of Transaction: 08/27/2013	
CUSTOMER:	
CONNIE HALEY PO BOX 584 GREEN VALLEY, AZ 85622 US	

LINE #	QTY	DESCRIPTION	REMARKS	UNIT PRICE	TOTAL
1	1.00	LOCATABLE MINERALS / MINING CLAIMS- NOT NEW-UNADJUD, ONE AUTH NO. ONLY / MINING CLAIM MONEY RECEIVED CASES: AMC418628/\$840.00	MAINT FEE PYMNT (6) 2014	- n/a -	840.00
TOTAL:					\$840.00

PAYMENT INFORMATION			
1	AMOUNT:	840.00	POSTMARKED: 08/24/2013
	TYPE:	CHECK	RECEIVED: 08/26/2013
	CHECK NO:	644	
	NAME:	HALEY, GARY L PO BOX 584 GREEN VALLEY AZ 85622 US	

REMARKS

This receipt was generated by the automated BLM Collections and Billing System and is a paper representation of a portion of the official electronic record contained therein.

UNITED STATES
DEPARTMENT OF THE INTERIOR
BUREAU OF LAND MANAGEMENT

1578

MAINTENANCE FEE WAIVER CERTIFICATION

AMC 418628
421122
421116
423064
FORM APPROVED 423063
OMB NO. 1004-0114 423704
Expires: October 31, 2016

SEE INSTRUCTIONS ON PAGE 2

- This small miner waiver is filed for the assessment year beginning on September 1, ~~2013~~²⁰¹⁴ and ending on September 1, ~~2014~~²⁰¹⁵.
- The undersigned and all related parties owned ten or fewer mining claims, mill, or tunnel sites located and maintained on Federal lands in the United States of America on September 1, ~~2014~~.
- The undersigned have performed the assessment work required by law for each mining claim listed prior to filing this waiver and understand that by filing this form, the undersigned must file an affidavit of assessment work with the Bureau of Land Management (BLM) by the December 30th following the filing of this waiver.
- The undersigned understand that if the assessment work obligation has not yet come due under 30 U.S.C. 28 (for those claims in their first assessment year only), a notice of intent to hold reciting this condition must be recorded by the December 30th following the filing of this waiver.
- The undersigned understand that mill and tunnel sites may also be listed on this waiver and be waived from payment of the maintenance fee, and that a notice of intent to hold for these sites is required to be filed with the BLM by the December 30th following the filing of this waiver.
- The undersigned understand and acknowledge that pursuant to 43 U.S.C. 1212 and 18 U.S.C. 1001, the filing or recording of a false, fictitious, or fraudulent document with the BLM may result in a fine of up to \$250,000, a prison term not to exceed five years, or both.
- The mining claims, mill or tunnel sites for which this waiver from payment of the maintenance fees is requested are:

CLAIM OR SITE NAME	BLM RECORDATION SERIAL NUMBER
1. Peachie	418628
2. Buzzards End	421122
3. Apache Moon	421116
4. Apache Moon 2	423064
5. Honeycomb	423063
6. Skid Mark	423704
7.	
8.	
9.	
10.	

RECEIVED
 BLM AZ STATE OFFICE
 20th AUG 27 PM 2:21
 PHOENIX, ARIZONA

The owner(s) (claimants) of the above mining claims and sites are:

Gary Haley
 (Owner's Name - Please Print)
 PO Box 584, Green Valley, AZ 85622
 (Owner's Mailing Address)

Gary Haley
 (Owner's Signature)
 Green Valley (City) AZ (State) 85622 (Zip Code)

Connie Haley
 (Owner's Name - Please Print)
 PO Box 584, Green Valley, AZ 85622
 (Owner's Mailing Address)

Connie L. Haley
 (Owner's Signature)
 Green Valley (City) AZ (State) 85622 (Zip Code)

 (Owner's Name - Please Print)

 (Owner's Mailing Address)

 (Owner's Signature)
 _____ (City) _____ (State) _____ (Zip Code)

 (Owner's Name - Please Print)

 (Owner's Mailing Address)

 (Owner's Signature)
 _____ (City) _____ (State) _____ (Zip Code)

(Continued on page 2)

ENTERED
 SEP 15 2014
 BY: *DM*

NWJ
 9/23/2014
DM

(Owner's Name - Please Print)	(Owner's Signature)
(Owner's Mailing Address)	(City) (State) (Zip Code)
(Owner's Name - Please Print)	(Owner's Signature)
(Owner's Mailing Address)	(City) (State) (Zip Code)
(Owner's Name - Please Print)	(Owner's Signature)
(Owner's Mailing Address)	(City) (State) (Zip Code)
(Owner's Name - Please Print)	(Owner's Signature)
(Owner's Mailing Address)	(City) (State) (Zip Code)

18 U.S.C. 1001 and 43 U.S.C. 1212 make it a crime for any person knowingly and willfully to make to any department or agency of the United States any false, fictitious or fraudulent statements or representations as to any matter within its jurisdiction.

INSTRUCTIONS

1. This certification is made under the provisions of 43 U.S.C. § 1744 and 30 U.S.C. §28-28k and the regulations thereunder (43 CFR Part 3830).
2. The claimant(s) must fill in the dates in paragraph 1 for the beginning and ending of the assessment year for which this waiver is sought.
3. The claimant(s) must fill in the date in paragraph 2 for the beginning of the assessment year for which this waiver is sought.
4. All claim and site names and BLM serial numbers must be listed for the mining claims, mill sites, and tunnel sites for which the waiver is sought.
5. All owners of the mining claims, mill sites, and tunnel sites and their addresses must be given.
6. This waiver form must be signed by all the claimants or their designated agent, in original form. If an agent is designated, a notarized designation of agent, signed by all of the claimants with proper address given, must be submitted with this waiver.
7. This form must be filed no later than September 1st for the upcoming assessment year in the BLM State Office where the mining claims or sites are recorded, or the waiver cannot be granted by the BLM. (Example: To obtain a waiver for the assessment year 2012, which begins on September 1, 2011, you must qualify for and file for a waiver no later than September 1, 2011, in the proper BLM State Office.)
8. For all mining claims which require assessment work, you must record an affidavit of labor on or before the December 30th immediately following the filing of this waiver. For all other mining claims or sites waived, you must record a notice of intent to hold on or before the December 30th immediately following the filing of this waiver.
9. Mill and tunnel sites may also be listed on this waiver and be waived from payment of the maintenance fee. A notice of intent to hold for these sites is required to be filed by the December 30th following the filing of this waiver.

RECEIVED
 BLM AZ STATE OFFICE
 PHOENIX, ARIZONA
 JUN 27 P 2:21

FOR OFFICIAL USE ONLY

NOTICE OF INTENTION TO HOLD MINING CLAIMS/SITES
page 2

BLM
Date
Stamp

RECEIVED
BLM AZ STATE OFFICE
PHOENIX, ARIZONA
2011 AUG 27 P 2:21

1. State of Arizona, County of Pima

2. I (Name) Connie Haley & Gary Haley

3. Reside at (Address) 16621 Horse Hollow Trail

City Sahuarita County Pima State AZ Zip 85629 being duly sworn, depose and say that I am a citizen of the United States, more than eighteen years of age, that all of the facts set forth in this notice, subject to the provisions and penalties of 18 U.S.C. 1001 pertaining to the filing of false, fictitious, or fraudulent statements with the United States, are true and correct according to the best of my knowledge, information and belief.

4. Owner's name and address (If not shown in Items 1-3 above).

5. Dated: Aug 26 2011 Signature: Gary Haley Connie Lee Haley

Bureau of Land Management
Arizona State Office
www.az.blm.gov

No. of Claims: 6 x \$10 = \$60
Check No: 801 Init. CH
Receipt No.: 3115369
For BLM Use Only

UNITED STATES
DEPARTMENT OF THE INTERIOR
BUREAU OF LAND MANAGEMENT

FORM APPROVED
OMB NO.: 1004-0114
Expires: October 31, 2016

418628
421122
421116
423063
423064
423704

AFFIDAVIT OF ANNUAL ASSESSMENT WORK

WHEN RECORDED, MAIL DOCUMENT TO:

NAME: Gary & Connie Haley

ADDRESS: PO Box 584

CITY, STATE, ZIP: Green Valley, AZ 85622

FOR COUNTY RECORDER'S USE

No. of Claims 6
x \$10/claim
Total due BLM \$ 60.

TO ALL WHOM IT MAY CONCERN:

1. The undersigned certifies that at least \$100 per claim was expended for development, labor and improvements, or equivalent value added, as the annual assessment work for the assessment year ending September 1, 2014 for the following contiguous unpatented mining claim(s), located in the County of Pima, in the State of Arizona.

BLM Serial No.	Name of Claim	Tp	Rg	Sec	Mer	County Recordation Book and Page No.	Date
418628	Peachie	17 S	12 E	003	Gila & S	20123130204 page 3	11/08/2012
421122	Buzzards End	17 S	10 E	026	Gila & S	20130590127 page 2	2/28/2013
421116	Apache Moon	17 S	10 E	026	Gila & S	20130590128 page 2	2/28/2013
423064	Apache Moon 2	17 S	10 E	026	Gila & S	20131420840 page 3	5/22/2013
423063	Honeycomb	17 S	10 E	026	Gila & S	20131420839 page 3	5/22/2013
423704	Skid Mark	17 S	10 E	026	Gila & S	20132050174 page 2	7/24/2013

RECEIVED
BLM STATE OFFICE
2014 AUG 27 P 2:21
PHOENIX, ARIZONA

(Continued on page 2)

INTERED
AUG 29 2014
BY: Ran

RECEIPT # 3115369

2. Type of labor and improvements (specify what was done and give the total value for that labor and improvement to show at least \$100 for each claim). If a geological, geochemical, or geophysical survey was performed, as per 30 U.S.C. 28-1, reference the title of the report of survey, give cost and date of the survey and report, and indicate it was filed with the County Recorder:

Description of Work Performed	Value of Work Performed	Date Work Was Performed
Roadwork (potholes filled), trash cleanup.	\$200.	October 7, 2013
Leveled road, jackhammer work, brush/ rock removal, etc.	\$600.	January 4, 2014
Fixed washed out road, remove roadblock & cut brush.	\$250.	March 16, 2014
Removed brush from blocking the roads.	\$100.	April 8, 2014
Backfilled holes on claim roads.	\$250.	May 5, 2014

3. Name and mailing address of each person who performed the labor and improvements:

Name (please print)

Gary Haley

 Connie Haley

Current Mailing Address (please print)

PO Box 584, Green Valley, AZ 85622

 PO Box 584, Green Valley, AZ 85622

4. Name and mailing address of each person who holds and claims the subject mining claim(s) for the valuable minerals contained therein. Be sure to indicate if there is a change of address:

Name (please print)

Gary Haley

 Connie L Haley

Current Mailing Address (please print)

PO Box 584, Green Valley, AZ 85622

 PO Box 584, Green Valley, AZ 85622

RECEIVED
 BLM AZ STATE OFFICE
 2014 AUG 27 10 21
 PHOENIX, ARIZONA

5. The undersigned testifies that on the date of August 26, 2014, all monuments required by law were erected upon the subject claim(s), and all notices required by law were posted on the subject claim(s) or copies thereof were in place, and at said date, each corner monument bore or contained

markings sufficient to appropriately designate the corner of the claim to which it pertains and the name of the claim(s).

I hereby certify under penalty of perjury under the laws of the State of Arizona that the foregoing statements are true and correct:

Gary Halcy Date: 8-25-2014
(Signature of person responsible for above statement)

Title 18 U.S.C. 1001 and 43 U.S.C. 1212 make it a crime for any person knowingly and willfully to make to any department or agency of the United States any false, fictitious or fraudulent statements or representations as to any matter within its jurisdiction.

Notary Block

SUBSCRIBED AND SWORN TO before me, this 25 day of August 2014
By: Victoria Ochoa
(Signature of Affiant)
Title: Notary Public
My Commission Expires: 9/30/2014

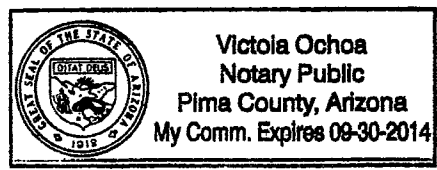

INSTRUCTIONS

- 1. This is an optional form that may be used to satisfy the requirements for the Bureau of Land Management (BLM) under the provisions of 43 U.S.C. §1744 and 30 U.S.C. §28-28d and the regulations thereunder (43 CFR part 3835). Since local and State laws may vary, you should contact your local and State agencies where the claims are located to ensure all applicable laws and requirements are satisfied.
- 2. The claimant(s) must fill in the date in paragraph 1 for the applicable assessment year and the county and state where the claims are located.
- 3. All claim names, BLM serial numbers, legal descriptions, and original county recording information must be listed for the claims pertaining to this assessment notice.
- 4. The claimant(s) must complete paragraph 2 listing all labor or improvements which was performed on or did benefit the subject mining claims. The value and date of the labor or improvements must also be listed. The total amount of labor or improvements can be listed, but the total expenditure must equal at least \$100 for each claim.
- 5. The names and current mailing addresses of the person(s) performing the labor shall be listed in paragraph 3.
- 6. The name and current mailing address of each owner (claimant) of the claims shall be listed in paragraph 4. The mailing address shall be the owner's address and not the address of an agent or anyone representing the claimant. Be sure to note if there has been a change of address.
- 7. Paragraph 5 shall be completed to show the date it was verified that all monuments required by law were properly erected, all notices were posted, and that corners were appropriately designated for all claims listed.
- 8. An exact legible reproduction or duplicate (other than microfilm or other electronic media) of this affidavit or another type of affidavit of assessment work that you file or will file in the county where each claim is located, must be filed with the BLM on or before December 30 of the calendar year in which the assessment year ends. For mill or tunnel sites, a separate notice of intent to hold must be filed with the BLM on or before December 30. Requirements for filing a notice of intent to hold can be found at 43 CFR 3835.33.
- 9. A processing fee of \$10 for each claim listed must be remitted to the BLM along with this or any other affidavit of assessment work.

RECEIVED
BLM
STATE OFFICE
PIMA COUNTY ARIZONA
AUG 27 2:11

Connie & Gary Haley
PO Box 584
Green Valley, AZ 85622



7012 2920 0000 3116 0080



1000

85004

U.S. POSTAGE
PAID
GREEN VALLEY, AZ
AUG 25 '14
AMOUNT

\$4.49

00075310-05

BLM
one North Central Ave. Suite 800
Phoenix AZ 85004-4427

PHOENIX, ARIZONA

2014 AUG 21 P 2:21

RECEIVED
BLM AZ STATE OFFICE

NOTICE OF INTENTION TO HOLD MINING CLAIMS/SITES

When Recorded Return Document to:

Gary & Connie Haley
P.O. Box 584
Green Valley, AZ 85622

RECEIVED
 BLM PHOENIX OFFICE
 2014 NOV 17 P 3:13
 PHOENIX, ARIZONA

BLM
 Date
 Stamp

Check here if this is a change of address.

Telephone: 520 648-2040

E-mail Address adamsplace773@peoplepc.com

I (We) intend to hold the claims(s) and/or site(s) listed below for the calendar year 2014, and I (We) have filed or will file a Notice of Intent to Hold in the county where the claim (s) is located.

Reason for filing a Notice of Intent to Hold instead of an assessment work filing (check one):

- Maintenance fee was paid to maintain claim(s) during this assessment year.
- Mill or tunnel sites.
- Claim(s) was located during the current assessment year.
- BLM has deferred assessment work (attach copy of decision granting deferment, or pending petition for deferment including date petition was filed.)

Line No.	AMC NUMBER	CLAIM/SITE NAME	COUNTY RECORDER DATA (If available)	TWP	RNG	SEC
1	418628	Peachie	20123130204 P93	17S	12E	003
2	421122	Buzzards End	20130590127 P92	17S	10E	026
3	421116	Apache Moon	20130590129 P92	17S	10E	026
4	423064	Apache Moon 2	20131420840 P93	17S	10E	026
5	423063	Honeycomb	20131420839 P93	17S	10E	026
6	423704	Skid Mark	20132050174 P92	17S	10E	026
7						
8						
9						
10						

ENTERED
 DEC 03 2014
 BY: RM

SENT BOTH NOE &
 POL. NOE REQUIRED.

NOTICE OF INTENTION TO HOLD MINING CLAIMS/SITES
page 2

RECEIVED
BLM ARIZONA STATE OFFICE
2014 NOV 17 P 3:13
PHOENIX, ARIZONA
BLM
Date
Stamp

1. State of Arizona, County of Pima

2. I (Name) Gary + Connie Haley

3. Reside at (Address) PO Box 584

City Green Valley County Pima State AZ Zip 85622 being duly sworn, depose and say that I am a citizen of the United States, more than eighteen years of age, that all of the facts set forth in this notice, subject to the provisions and penalties of 18 U.S.C. 1001 pertaining to the filing of false, fictitious, or fraudulent statements with the United States, are true and correct according to the best of my knowledge, information and belief.

4. Owner's name and address (If not shown in Items 1-3 above).

5. Dated: 11-10-14 Signature: Gary Haley - Connie Lee Haley

Bureau of Land Management
Arizona State Office
www.az.blm.gov

No. of Claims: _____ x \$10 = _____
Check No: _____ Init. _____
Receipt No.: 3115369
For BLM Use Only
paid

Connie & Gary Haley
PO Box 584
Green Valley, AZ 85622

PHOENIX AZ 850

15 NOV 2014 PM 6 L

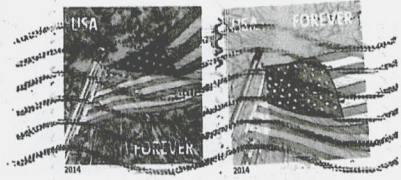

RECEIVED
SUN AZ STATE OFFICE

2014 NOV 17 P 3:06 BLM

PHOENIX, ARIZONA Arizona State office
one North Central Ave. suite 800
Phoenix, AZ 85004-4427
ATTN: Re'Ann Myers

85004442700



United States Department of the Interior
Bureau of Land Management
 LANDS/RECREATION & PLANNING
 ONE N CENTRAL AVE
 PHOENIX, AZ 85004 -2203
 Phone: 602-417-9200

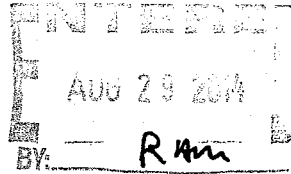

Receipt

No:

3115369

Transaction #: 3207111	
Date of Transaction: 08/28/2014	
CUSTOMER:	
GARY L HALEY PO BOX 584 GREEN VALLEY, AZ 85622-0584 US	

LINE #	QTY	DESCRIPTION	REMARKS	UNIT PRICE	TOTAL
1	1.00	LOCATABLE MINERALS / MINING CLAIMS-NOT NEW-UNADJUD, ONE AUTH NO. ONLY / MINING CLAIM MONEY RECEIVED CASES: AMC418628/\$60.00	MAINT FEE WAIVER (6) 2015 / POL (6) 2014 / NOI (2ND PAGE ONLY)	- n/a -	60.00
TOTAL:					\$60.00

PAYMENT INFORMATION					
1	AMOUNT:	60.00	POSTMARKED:	08/25/2014	
	TYPE:	CHECK	RECEIVED:	08/27/2014	
	CHECK NO:	801			
	NAME:	HALEY, GARY L PO BOX 584 GREEN VALLEY AZ 85622-0584 US			

REMARKS

This receipt was generated by the automated BLM Collections and Billing System and is a paper representation of a portion of the official electronic record contained therein.

NOTICE!!

These documents have been scanned!

Do not place un-scanned documents beneath this notice!

Do not remove this notice from this file!

GPO Jacket No. 560-102
Print Order 61540
Rise Business Services, LLC
Job=AZ15 5/13/2019



Box Number= AZ15040



Claim Begin-End: AMC423063-AMC423063

6 Location Notices-Amendments and Supporting Documents



AZ15040-13

AMC422569-AMC423150

**DEPARTMENT OF THE INTERIOR
BUREAU OF LAND MANAGEMENT
MINING CLAIMS
(LIVE) Serial Register Page**

Run Date/Time: 06/10/2013 09:53 AM

Page 1 of 1

01 05-10-1872;017STAT0091;30USC26,28,34

Total Acres

Serial Number

Case Type 384101: LODE CLAIM

20.660

AMC423063

Claim Name: HONEY COMB

Lead File Number

Commodity :

AMC423063

Case Disposition: ACTIVE

Required Maintenance Fee: \$140.00

Name & Address			Int Rel
HALEY CONNIE	PO BOX 584	GREEN VALLEY, AZ 85622-0584	CLAIMANT
HALEY GARY	PO BOX 584	GREEN VALLEY, AZ 85622-0584	CLAIMANT

Mer Twp	Rng	Sec	Quadrant	District/Field Office	County
14	0170S	0100E	026 SW,SE	TUCSON FO	PIMA

Act Date	Code	Action	Action Remarks	Receipt Number
04/12/2013	403	LOCATION DATE		
05/03/2013	395	RECORDATION NOTICE RECD	1	2787280
05/03/2013	484	LOCATION YEAR / MAINTENANCE	2013;\$140	2787280
05/03/2013	501	ACCT ADV IN LEAD FILE	AMC423063;	



Line Nr Remarks

NO WARRANTY IS MADE BY BLM
FOR USE OF THE DATA FOR
PURPOSES NOT INTENDED BY BLM

MINING CLAIM STATUS REPORT

DATA ENTERED JUN 10 2013 *pb*

MTP Checked by JUN 10 2013 *pb*

GEO Checked by JUN 10 2013 *pb*

LEAD SERIAL NUMBER AMC 423063 thru AMC

OF CLAIMS & TYPE

1 LODE
 # PLACER
 # ASSOCIATION PLACER
 # MILL SITE
 # TUNNEL SITE

CHARGES

Location Fee @ \$34 = \$ 34.00
 Processing Fee @ \$15 = \$ 15.00
 Maintenance Fee @ \$140 = \$ 140.00
 Overage (+) \$
 Shortage (-) \$
 Other Fees \$
TOTAL \$ 189.00

TOTAL CLAIM ACREAGE? 20.66

OF LOCATORS? 2

DOCUMENTS RECEIVED VIA -

Over-the-Counter [] Mail

TIMELY FILED?

Yes No []

LEGAL DESCRIPTION - T 17S R 10E SEC 26
 T R SEC
 T R SEC
 T R SEC

BLM [] FOREST SERVICE [] SUBJ TO PL 359: Yes [] No []

WILDERNESS AREA: No [] Yes []

SPLIT ESTATE - N/A [] SX [] PX [] SRHA [] OTHER []

Proper Notice Filed if Located on SHRA Lands? N/A [] Yes [] No []

RECONVEYED MINERALS ON BLM LANDS REQUIRE OPENING ORDERS FROM 1944 TO 1993 -

Open to Entry on: N/A []

COMMENTS/STATUS - VOID [] PARTIALLY VOID [] PVT MINERALS [] WITHDRAWN LANDS []

OTHER []

Claimant acknowledges that portions of the following claims(s) site(s) may be void or voidable.

Printed Name of Claimant Signature of Claimant

***** FINAL ADJUDICATION *****

DATE JUN 10 2013 INITIALS pb

AHC423063

LOCATION NOTICE FOR LODE MINING CLAIM

NOTICE IS HEREBY GIVEN that the _____
Honeycomb lode mining claim has been located
by Connie Haley + Gary Haley whose current mailing
address is PO BOX 584 Green Valley, Arizona
85622

RECEIVED
BLM AZ STATE OFFICE
PHOENIX, ARIZONA
2013 MAY -3 PM 2:49
BLM
Date
Stamp

The general course of this claim is S.E. to N.W. and it is situated in Pima
County, Arizona. This claim is 1500 feet in length and 600 feet in width. This claim runs
from the location monument on which this location notice is posted approximately 1500 feet in a
~~Northern~~ direction to the North end line and 0 feet in a Southern direction to the
Southern end line. This claim is marked by six monuments, one at each corner and one at the center of each
end line of the claim.

The location monument on which this notice is posted is situated within Section 026, Township 17
S, Range 10 E, Gila Salt River Base and Meridian, Arizona and this claim encompasses portions
of the following quarter section (s), section (s), Township (s) and Range (s) SE + SW 1/4 of Section 026
Township 17, South, Range 12 East.

Gila Salt River Base and Meridian, Arizona.

The locality of this claim with reference to some natural object or permanent monument and additional information
(if any) concerning its locality are as follows: Location Marker is 0.8 miles E. of Providencia
Hill + 0.9 miles N.E. of Stevens Mountain, Longitude + Latitude of Location
Marker (C+R line A-B) is N. 31° 54.935' - W. 111° 17.349' (+) N. 31° 55.152' - W. 111° 17.480

DATED AND POSTED on the ground this 12 day of April, 20 13.

LOCATOR (s) Connie L. Haley, Gary Haley

Form MCF100
Revised July 2005

AN0423063

RECEIVED
BLM AZ STATE OFFICE
PHOENIX, ARIZONA
2013 MAY -3 PM 2:49

MINING CLAIM MAP

Lode Placer ()

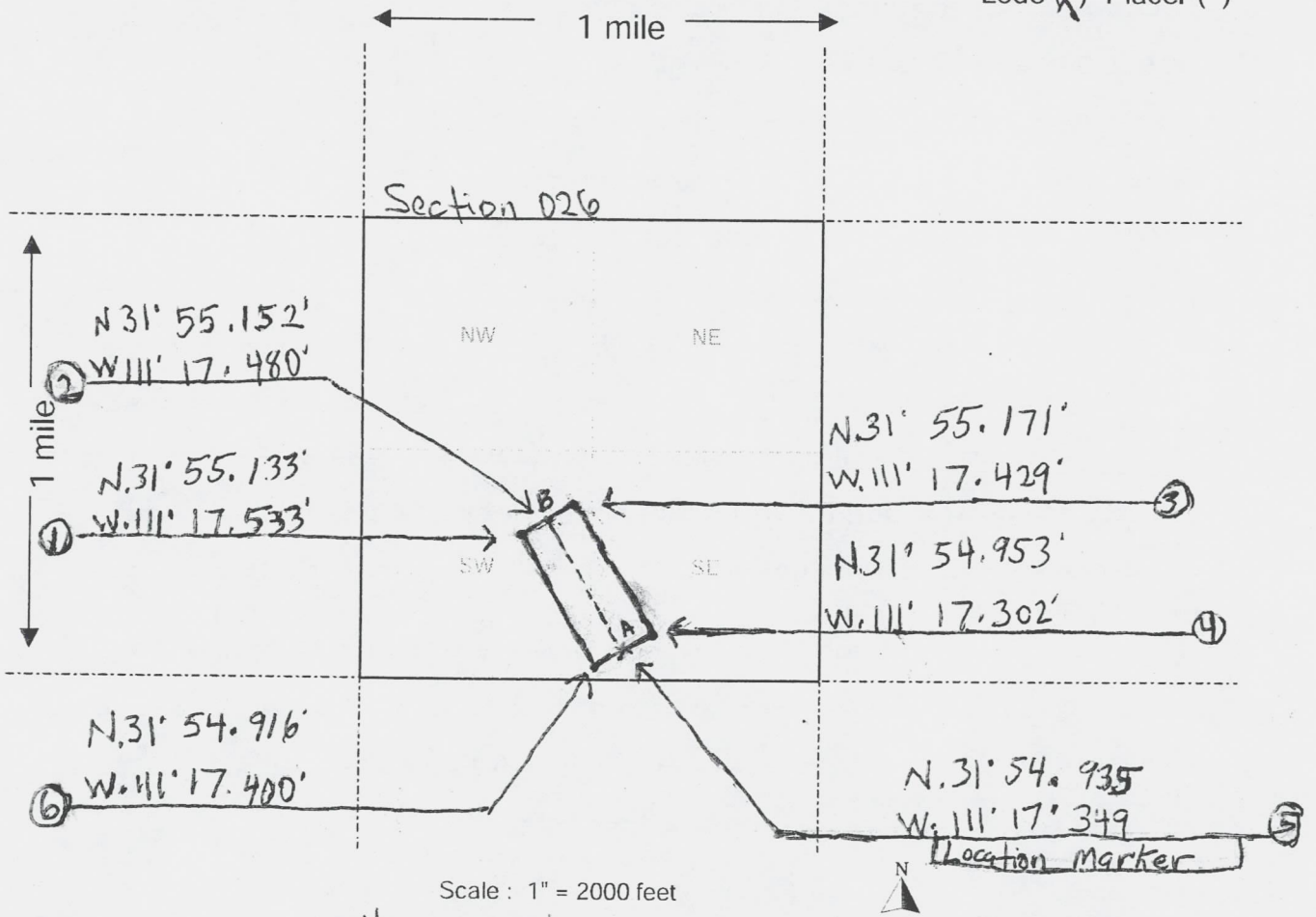

1. The above map depicts the Honeycomb mining claim, which is located in Section (s) 026, Township 17 S, Range 10 E, Gila and Salt River Base and Meridian, Pima County, Arizona.

2. The type of corner and location monuments used are as follows: Wooden stakes with Stones
Location notice attached inside plastic bottle on monument post.

3. The bearings and distances in degrees and feet between claim corners are as depicted on the map.

Form MCF100a
Revised July 2005

This form is available from the Arizona Department of Mines & Mineral Resources and may be reproduced.

AMC423063



Connie Haley
PO Box 584
Green Valley, AZ 85622-0584

PHOENIX AZ 852

02 MAY 2013 PM 1 L



RECEIVED
BLM AZ STATE OFFICE

2013 MAY -3 PM 2: 45

PHOENIX, ARIZONA

*Bureau of Land Management
Arizona State office
1 North Ave, Suite 800
Phoenix, AZ, 85004-4427*

85004442700

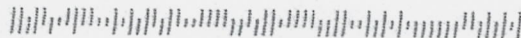



Connie Haley
PO Box 584
Green Valley, AZ 85622-0584

PHOENIX AZ 852

02 MAY 2013 PM 1 L



Justice
FOREVER

RECEIVED
BLM AZ STATE OFFICE

2013 MAY -3 PM 2: 45

PHOENIX, ARIZONA

*Bureau of Land Management
Arizona State office
1 North Ave, Suite 800
Phoenix, Az, 85004-4427*

85004442700



RUN TIME: 09:59 AM

RUN DATE: 06/10/2013

Page 1 of 1

DEPARTMENT OF INTERIOR
BUREAU OF LAND MANAGEMENT

Input Parameters for Geographic Report with Land

System Id = CR

Admin State = AZ

Geo State = AZ

Casetype Begins With

Case Disp Txt = AUTHORIZED, CANCELLED, EXPIRED, PENDING, REJECTED, RELINQUISHED, WITHDRAWN

Mer Twp Rng =

Section =

Mtrs = 14 0170S 0100E 026, 14 0170S 0100E 999

Commodity =

Commodity Txt =

Pending Org =

Pend Org Decode =

Total Rows Returned: 0

NO WARRANTY IS MADE BY BLM FOR USE OF THE DATA
FOR PURPOSES NOT INTENDED BY BLM

